

MODERN SERIES

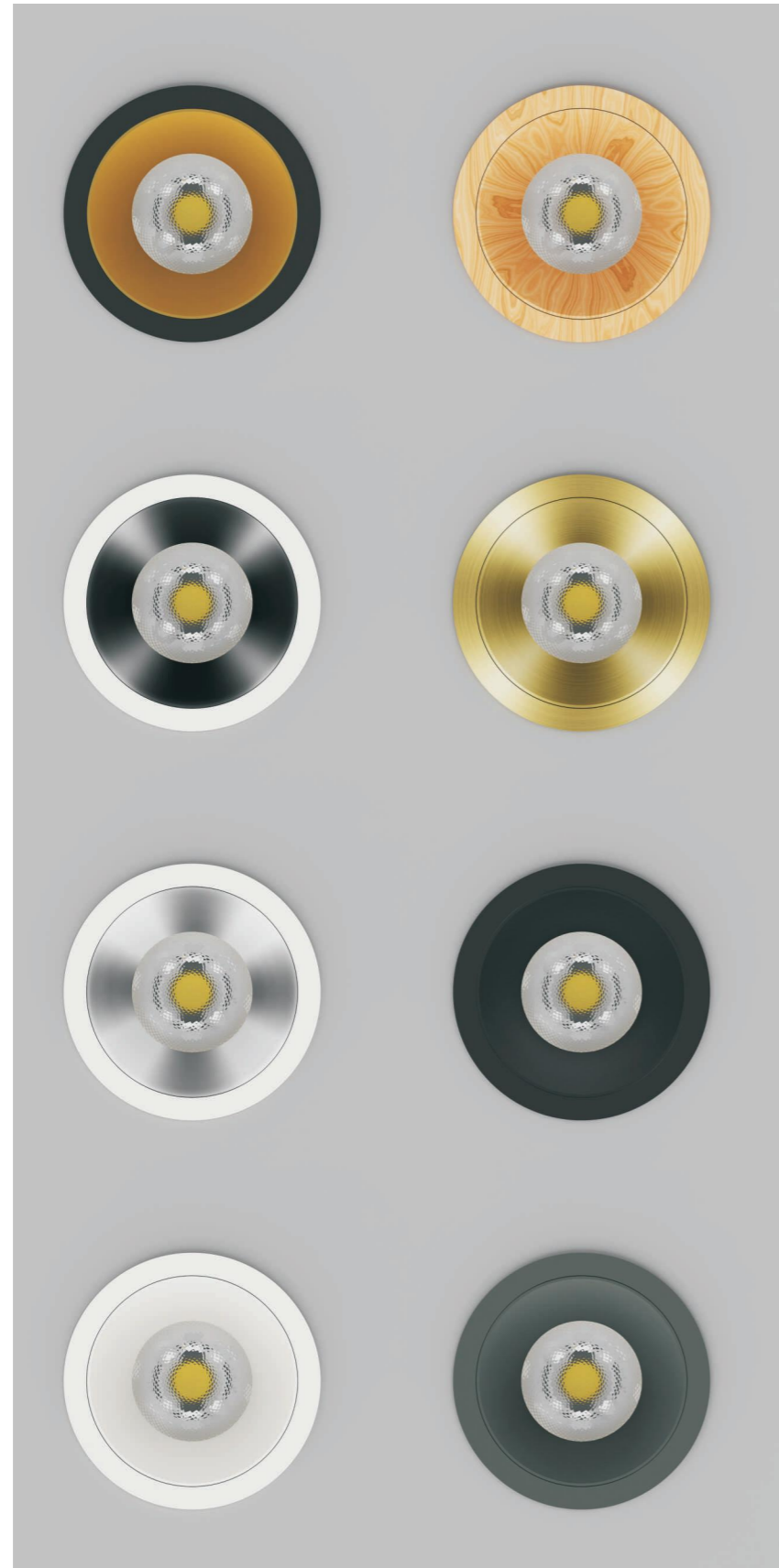

Versatile combinations and free colors meet the personalized needs of the space. In addition to meeting power requirements, it is also a form of decoration.

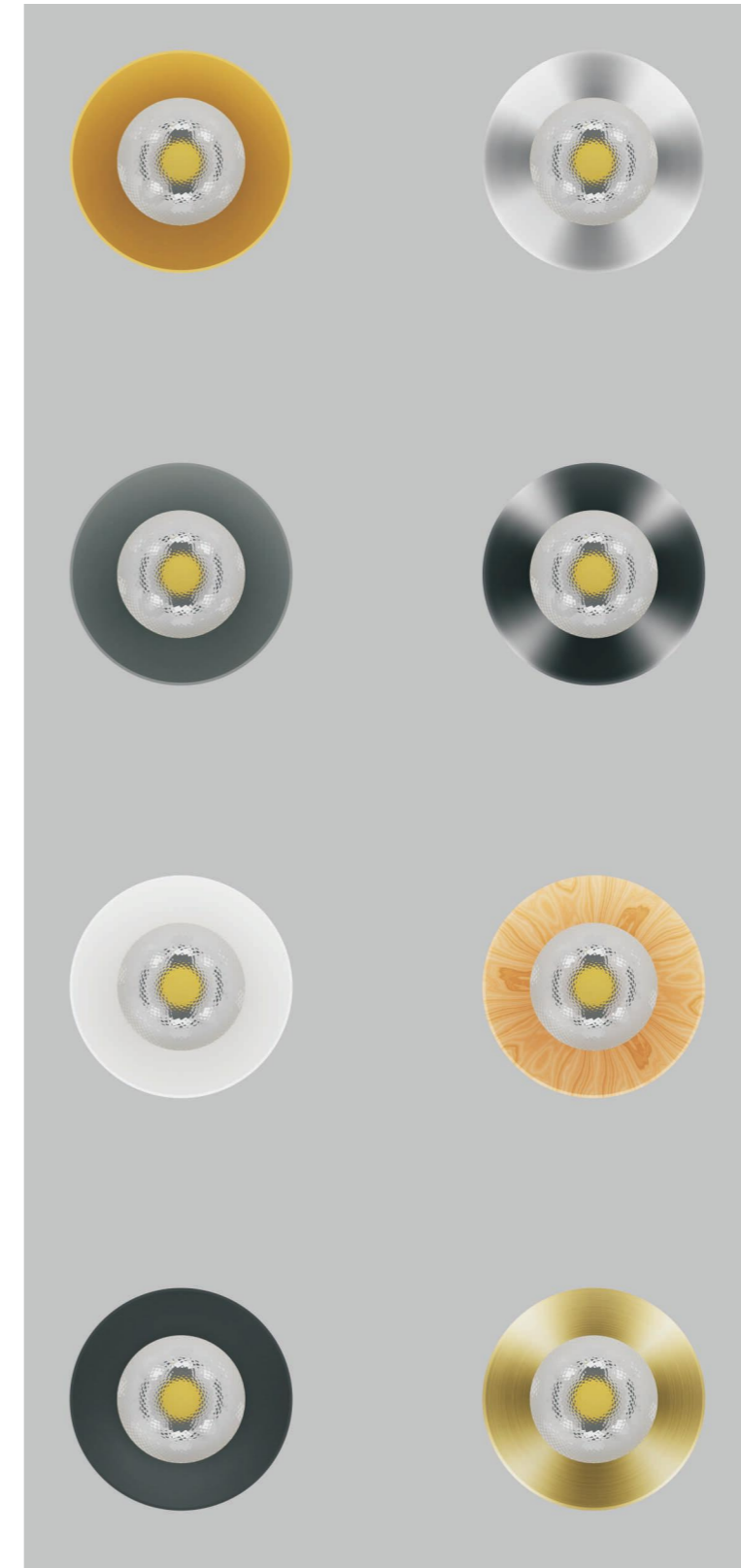





Shallow cup

Super anti-glare, no light stays at the ceiling.

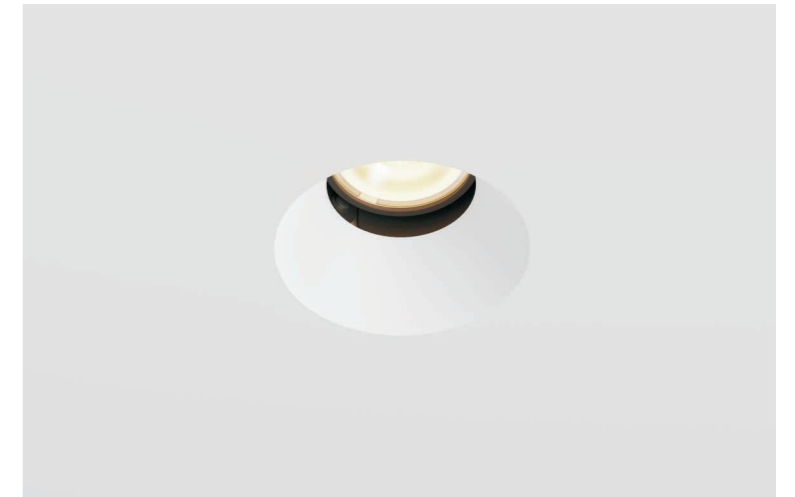

Deep cup

Trumpet-shaped deep-tube reflector; shimmer stays at the mouth of reflector, and the slight shimmers at the reflector are actually decorating the ceiling.

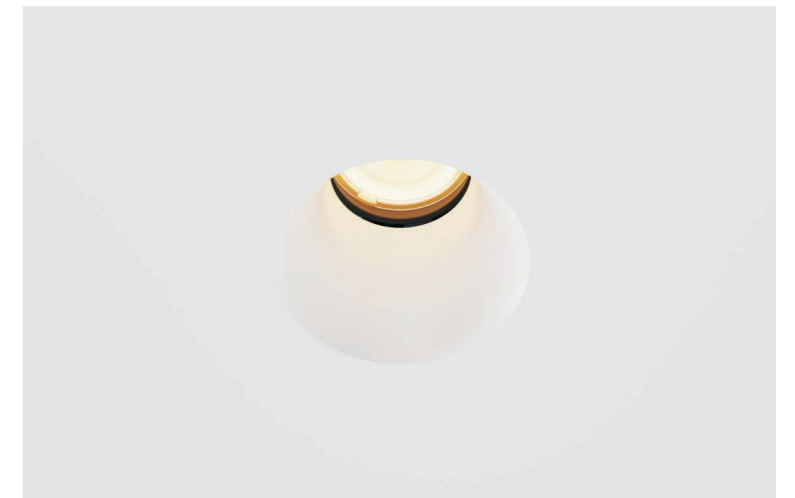

SIZE LINEUP

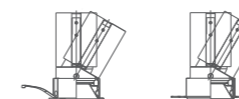

Narrow border No border



Beam Angle: ■ Extra Narrow ■ Narrow ■ Medium ■ Wide ■ Extra wide

C C T : ○ 2700K ○ 3000K ○ 3500K ○ 4000K ○ 5000K ○ 2700-6000K ○ 1800-4000K
○ DTW 1800-3000K ○ RGBCW

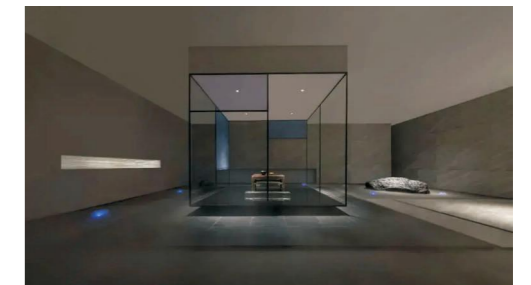



**Patent design,
easy to maintance**

Specially designed string hidden inside,
Easily pull out the led module when necessary

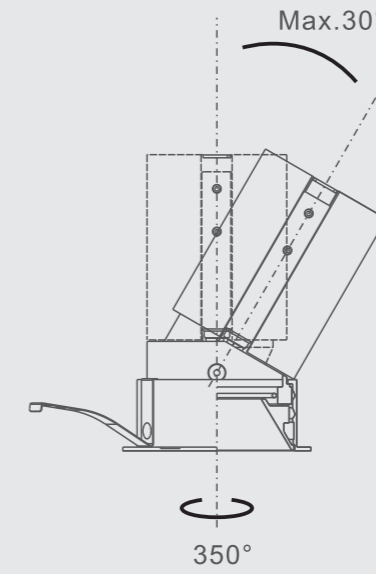

350°

Horizontal rotate angle

Max.30°

Vertical tilt angle

Flexible application,
easy to meet various angles of light projection.



Vertical lighting



Swing angle illumination



Glare Cut 50° 350° 30° UGR < 19

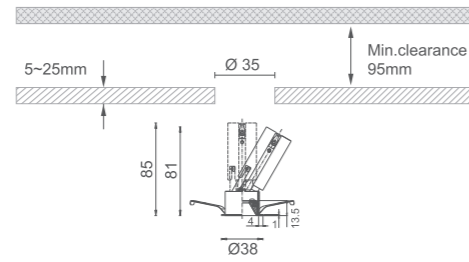

MODERN 21020AW

Colour(Front ring) ● Standard ○ Non-standard

- WHITE ●
- BLACK ●

IP rate ● Standard ○ Non-standard

- IP20 ●
- IP54 ●

CCT ● Standard ○ Non-standard

- 2700K ●
- 3000K ●
- 3500K ●
- 4000K ●
- 5000K ●
- 2700-6000K ●

Control ● Standard ○ Non-standard

- ON/OFF ●
- DALI ●
- 0/1-10V ●
- TRIAC ●
- BLUETOOTH ○
- ZIGBEE ○
- CASAMBI ○

Optical Accessories

When E01 is selected, the protection level is IP20; Choosing E02, E03, or E04 can achieve IP54 protection level; You can choose one or both: E01+E02, E01+E03, or E01+E04.

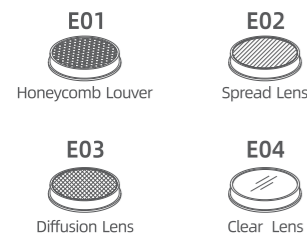

LED 4.5W/6W (CREE LED)

LED Power	System Power	LED Output	System Output	Beam	CCT	CRI	Drive
4.5W	6W	410lm	268lm	15°	3000K	> 90	12V 350mA
4.5W	6W	410lm	280lm	24°	3000K	> 90	12V 350mA
4.5W	6W	410lm	317lm	36°	3000K	> 90	12V 350mA
6W	8W	532lm	310lm	15°	3000K	> 90	12V 500mA
6W	8W	532lm	331lm	24°	3000K	> 90	12V 500mA
6W	8W	532lm	375lm	36°	3000K	> 90	12V 500mA

Light Distribution

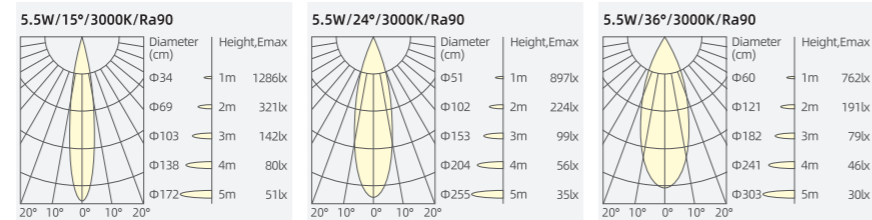

Colour(Reflector)

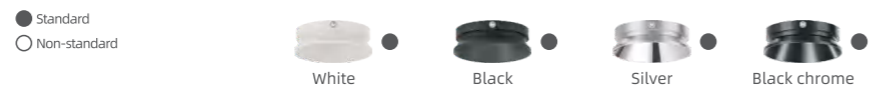

Glare Cut 37° 350° 0° UGR < 19

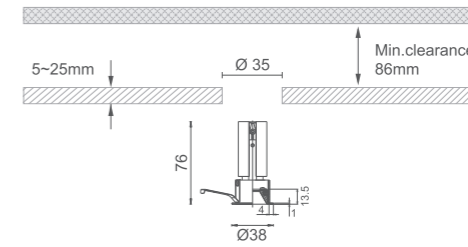

MODERN 21021AW

Colour(Front ring) ● Standard ○ Non-standard

- WHITE ●
- BLACK ●

IP rate ● Standard ○ Non-standard

- IP20 ●
- IP54 ●

CCT ● Standard ○ Non-standard

- 2700K ●
- 3000K ●
- 3500K ●
- 4000K ●
- 5000K ●
- 2700-6000K ●

Control ● Standard ○ Non-standard

- ON/OFF ●
- DALI ●
- 0/1-10V ●
- TRIAC ●
- BLUETOOTH ○
- ZIGBEE ○
- CASAMBI ○

Optical Accessories

When E01 is selected, the protection level is IP20; Choosing E02, E03, or E04 can achieve IP54 protection level; You can choose one or both: E01+E02, E01+E03, or E01+E04.

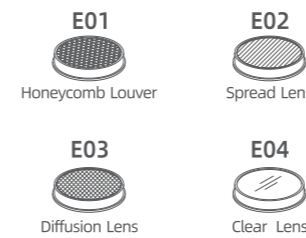

LED 4.5W/6W (CREE LED)

LED Power	System Power	LED Output	System Output	Beam	CCT	CRI	Drive
4.5W	6W	410lm	335lm	15°	3000K	> 90	12V 350mA
4.5W	6W	410lm	332lm	24°	3000K	> 90	12V 350mA
4.5W	6W	410lm	354lm	36°	3000K	> 90	12V 350mA
6W	8W	532lm	420lm	15°	3000K	> 90	12V 500mA
6W	8W	532lm	398lm	24°	3000K	> 90	12V 500mA
6W	8W	532lm	412lm	36°	3000K	> 90	12V 500mA

Light Distribution

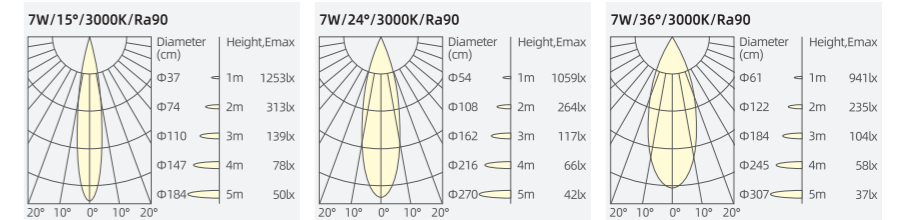

Colour(Reflector)





**MODERN
21023AW**

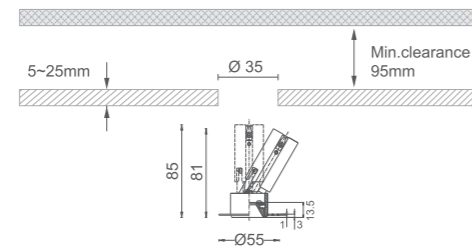

Colour(Front ring) ● Standard ○ Non-standard

- WHITE ●
- BLACK ●

IP rate ● Standard ○ Non-standard

- IP20 ●
- IP54 ●

CCT ● Standard ○ Non-standard

- 2700K ●
- 3000K ●
- 3500K ●
- 4000K ●
- 5000K ●
- 2700-6000K ●

Control ● Standard ○ Non-standard

- ON/OFF ●
- DALI ●
- 0/1-10V ●
- TRIAC ●
- BLUETOOTH ○
- ZIGBEE ○
- CASAMBI ○

LED 4.5W/6W (CREE LED)

LED Power	System Power	LED Output	System Output	Beam	CCT	CRI	Drive
4.5W	6W	410lm	268lm	15°	3000K	> 90	12V 350mA
4.5W	6W	410lm	280lm	24°	3000K	> 90	12V 350mA
4.5W	6W	410lm	317lm	36°	3000K	> 90	12V 350mA
6W	8W	532lm	310lm	15°	3000K	> 90	12V 500mA
6W	8W	532lm	331lm	24°	3000K	> 90	12V 500mA
6W	8W	532lm	375lm	36°	3000K	> 90	12V 500mA

Light Distribution

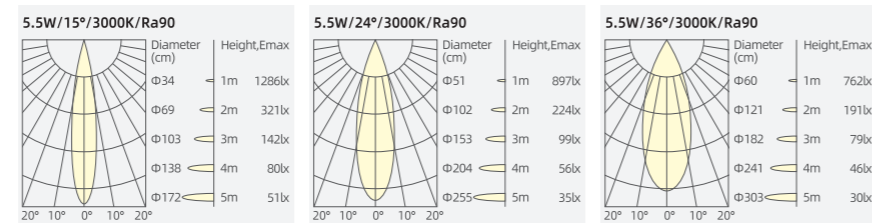

Colour(Reflector)



Optical Accessories

When E01 is selected, the protection level is IP20; Choosing E02, E03, or E04 can achieve IP54 protection level; You can choose one or both: E01+E02, E01+E03, or E01+E04.

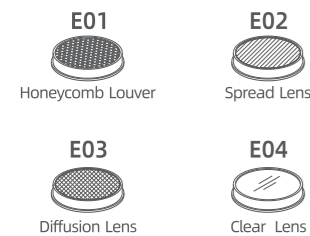

**MODERN
21024AW**

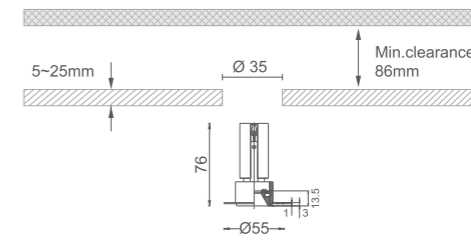

Colour(Front ring) ● Standard ○ Non-standard

- WHITE ●
- BLACK ●

IP rate ● Standard ○ Non-standard

- IP20 ●
- IP54 ●

CCT ● Standard ○ Non-standard

- 2700K ●
- 3000K ●
- 3500K ●
- 4000K ●
- 5000K ●
- 2700-6000K ●

Control ● Standard ○ Non-standard

- ON/OFF ●
- DALI ●
- 0/1-10V ●
- TRIAC ●
- BLUETOOTH ○
- ZIGBEE ○
- CASAMBI ○

LED 4.5W/6W (CREE LED)

LED Power	System Power	LED Output	System Output	Beam	CCT	CRI	Drive
4.5W	6W	410lm	335lm	15°	3000K	> 90	12V 350mA
4.5W	6W	410lm	332lm	24°	3000K	> 90	12V 350mA
4.5W	6W	410lm	354lm	36°	3000K	> 90	12V 350mA
6W	8W	532lm	420lm	15°	3000K	> 90	12V 500mA
6W	8W	532lm	398lm	24°	3000K	> 90	12V 500mA
6W	8W	532lm	412lm	36°	3000K	> 90	12V 500mA

Light Distribution

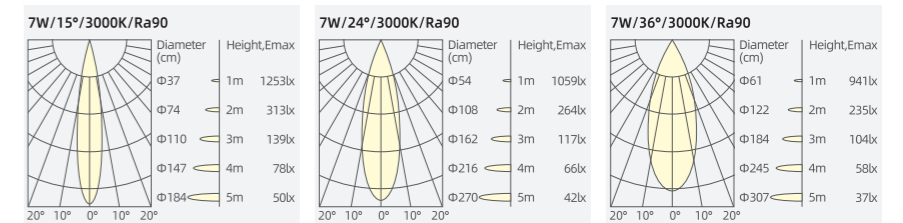

Colour(Reflector)



Optical Accessories

When E01 is selected, the protection level is IP20; Choosing E02, E03, or E04 can achieve IP54 protection level; You can choose one or both: E01+E02, E01+E03, or E01+E04.

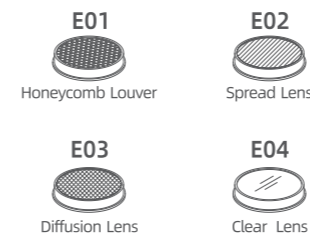



Glare Cut 37° | 350° | 25° | UGR < 19 | CE | CB

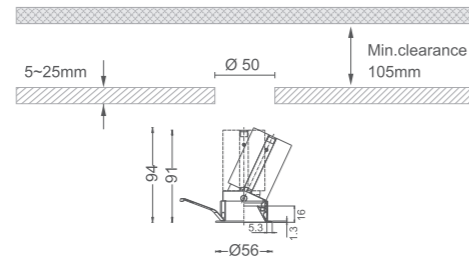

MODERN 12530AW

Colour(Front ring) ● Standard ○ Non-standard

- WHITE ●
- BLACK ●

IP rate ● Standard ○ Non-standard

- IP20 ●
- IP54 ●

CCT ● Standard ○ Non-standard

- 2700K ●
- 3000K ●
- 3500K ●
- 4000K ●
- 5000K ●
- 2700-6000K ●
- 1800-4000K ○
- DTW 1800-3000K ○

Control ● Standard ○ Non-standard

- ON/OFF ●
- DALI ●
- 0/1-10V ●
- TRIAC ●
- BLUETOOTH ○
- ZIGBEE ○
- CASAMBI ○

Optical Accessories

When E01 is selected, the protection level is IP20; Choosing E02, E03, or E04 can achieve IP54 protection level; You can choose one or both: E01+E02, E01+E03, or E01+E04.

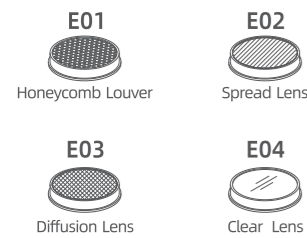

LED 4.5W/6.5W/8W (CITIZEN LED)

LED Power	System Power	LED Output	System Output	Beam	CCT	CRI	Drive
6.5W	7W	660lm	467lm	15°	3000K	> 90	34V 200mA
6.5W	7W	652lm	596lm	24°	3000K	> 90	32V 200mA
6.5W	7W	652lm	626lm	36°	3000K	> 90	32V 200mA
6.5W	7W	652lm	570lm	45°	3000K	> 90	32V 200mA
8W	9W	792lm	600lm	15°	3000K	> 90	34V 250mA
8W	9W	815lm	678lm	24°	3000K	> 90	32V 250mA
8W	9W	815lm	717lm	36°	3000K	> 90	32V 250mA
8W	9W	815lm	667lm	45°	3000K	> 90	32V 250mA

Light Distribution

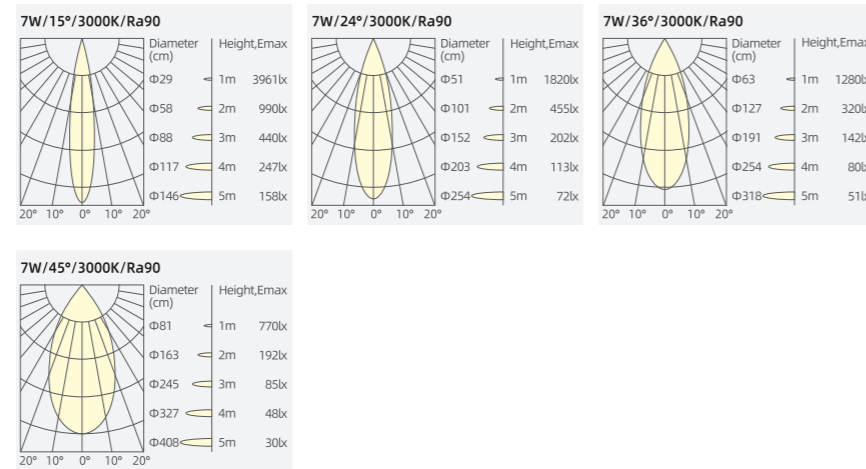

Colour(Reflector)



Glare Cut 37° | 350° | 0° | UGR < 19 | CE | CB

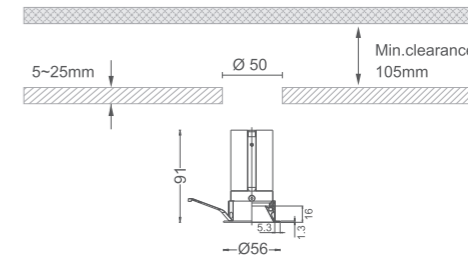

MODERN 12530AD

Colour(Front ring) ● Standard ○ Non-standard

- WHITE ●
- BLACK ●

IP rate ● Standard ○ Non-standard

- IP20 ●
- IP54 ●

CCT ● Standard ○ Non-standard

- 2700K ●
- 3000K ●
- 3500K ●
- 4000K ●
- 5000K ●
- 2700-6000K ●
- 1800-4000K ○
- DTW 1800-3000K ○

Control ● Standard ○ Non-standard

- ON/OFF ●
- DALI ●
- 0/1-10V ●
- TRIAC ●
- BLUETOOTH ○
- ZIGBEE ○
- CASAMBI ○

Optical Accessories

When E01 is selected, the protection level is IP20; Choosing E02, E03, or E04 can achieve IP54 protection level; You can choose one or both: E01+E02, E01+E03, or E01+E04.

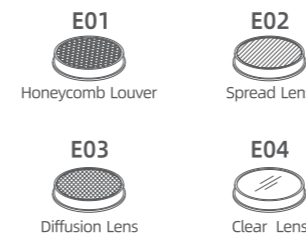

LED 4.5W/6.5W/8W (CITIZEN LED)

LED Power	System Power	LED Output	System Output	Beam	CCT	CRI	Drive
6.5W	7W	660lm	467lm	15°	3000K	> 90	34V 200mA
6.5W	7W	652lm	596lm	24°	3000K	> 90	32V 200mA
6.5W	7W	652lm	626lm	36°	3000K	> 90	32V 200mA
6.5W	7W	652lm	570lm	45°	3000K	> 90	32V 200mA
8W	9W	792lm	600lm	15°	3000K	> 90	34V 250mA
8W	9W	815lm	678lm	24°	3000K	> 90	32V 250mA
8W	9W	815lm	717lm	36°	3000K	> 90	32V 250mA
8W	9W	815lm	667lm	45°	3000K	> 90	32V 250mA

Light Distribution

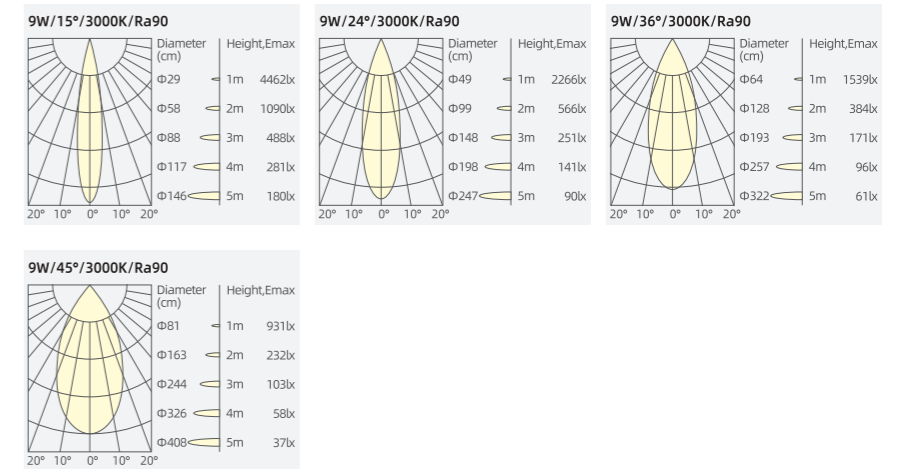

Colour(Reflector)





**MODERN
12532AW**

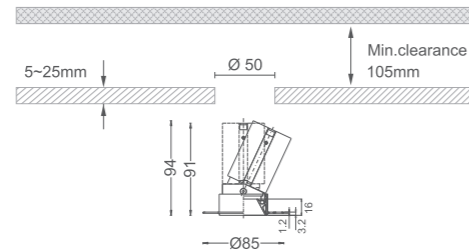

Colour(Front ring)

- Standard
- Non-standard
- WHITE
- BLACK

IP rate

- Standard
- Non-standard
- IP20
- IP54

CCT

- Standard
- Non-standard
- 2700K
- 3000K
- 3500K
- 4000K
- 5000K
- 2700-6000K
- 1800-4000K
- DTW 1800-3000K

Control

- Standard
- Non-standard
- ON/OFF
- DALI
- 0/1-10V
- TRIAC
- BLUETOOTH
- ZIGBEE
- CASAMBI

Optical Accessories

When E01 is selected, the protection level is IP20;
Choosing E02, E03, or E04 can achieve IP54 protection level;
You can choose one or both: E01+E02, E01+E03, or E01+E04.

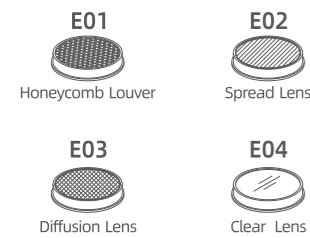

LED 4.5W/6.5W/8W (CITIZEN LED)

LED Power	System Power	LED Output	System Output	Beam	CCT	CRI	Drive
6.5W	7W	660lm	467lm	15°	3000K	> 90	34V 200mA
6.5W	7W	652lm	596lm	24°	3000K	> 90	32V 200mA
6.5W	7W	652lm	626lm	36°	3000K	> 90	32V 200mA
6.5W	7W	652lm	570lm	45°	3000K	> 90	32V 200mA
8W	9W	792lm	600lm	15°	3000K	> 90	34V 250mA
8W	9W	815lm	678lm	24°	3000K	> 90	32V 250mA
8W	9W	815lm	717lm	36°	3000K	> 90	32V 250mA
8W	9W	815lm	667lm	45°	3000K	> 90	32V 250mA

Light Distribution

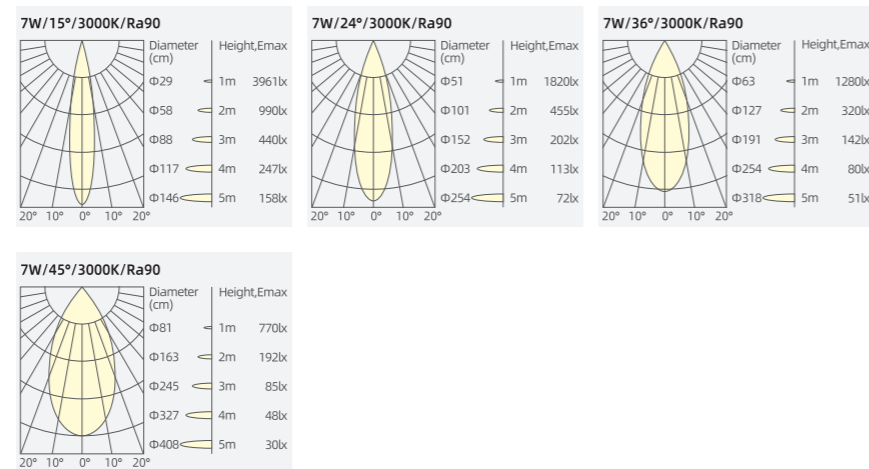

Colour(Reflector)

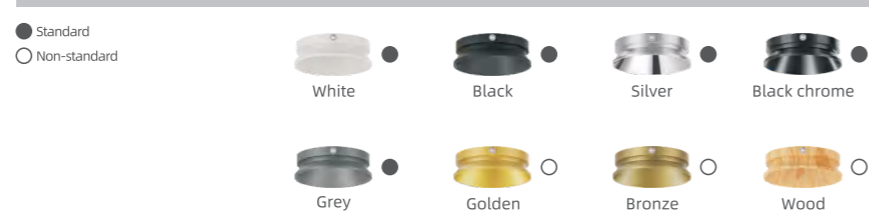

**MODERN
12532AD**

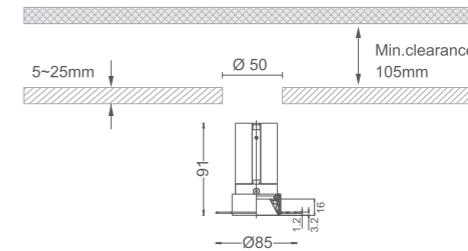

Colour(Front ring)

- Standard
- Non-standard
- WHITE
- BLACK

IP rate

- Standard
- Non-standard
- IP20
- IP54

CCT

- Standard
- Non-standard
- 2700K
- 3000K
- 3500K
- 4000K
- 5000K
- 2700-6000K
- 1800-4000K
- DTW 1800-3000K

Control

- Standard
- Non-standard
- ON/OFF
- DALI
- 0/1-10V
- TRIAC
- BLUETOOTH
- ZIGBEE
- CASAMBI

Optical Accessories

When E01 is selected, the protection level is IP20;
Choosing E02, E03, or E04 can achieve IP54 protection level;
You can choose one or both: E01+E02, E01+E03, or E01+E04.

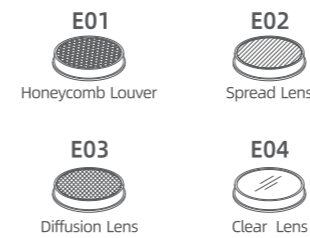

LED 4.5W/6.5W/8W (CITIZEN LED)

LED Power	System Power	LED Output	System Output	Beam	CCT	CRI	Drive
6.5W	7W	660lm	467lm	15°	3000K	> 90	34V 200mA
6.5W	7W	652lm	596lm	24°	3000K	> 90	32V 200mA
6.5W	7W	652lm	626lm	36°	3000K	> 90	32V 200mA
6.5W	7W	652lm	570lm	45°	3000K	> 90	32V 200mA
8W	9W	792lm	600lm	15°	3000K	> 90	34V 250mA
8W	9W	815lm	678lm	24°	3000K	> 90	32V 250mA
8W	9W	815lm	717lm	36°	3000K	> 90	32V 250mA
8W	9W	815lm	667lm	45°	3000K	> 90	32V 250mA

Light Distribution

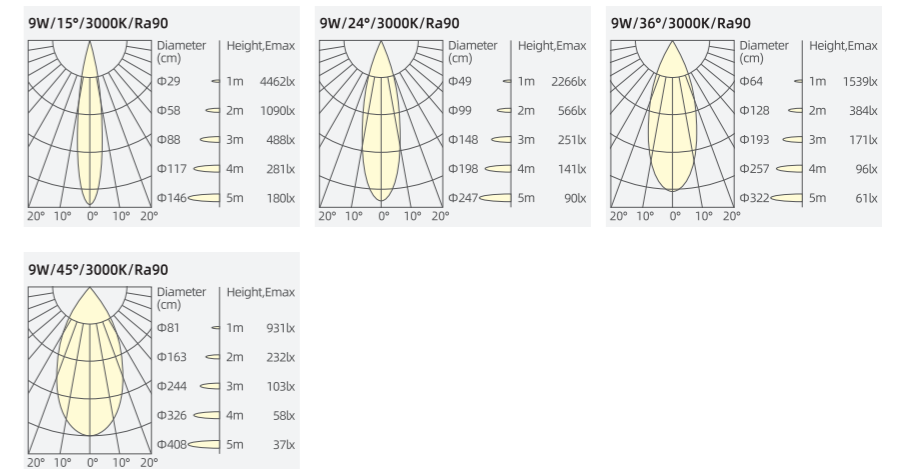

Colour(Reflector)





**MODERN
12540AW**

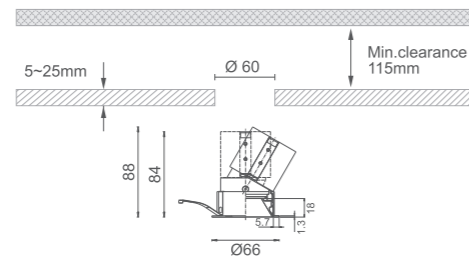

Colour(Front ring)

- Standard
- Non-standard
- WHITE ●
- BLACK ●

IP rate

- Standard
- Non-standard
- IP20 ●
- IP54 ●

CCT

- Standard
- Non-standard
- 2700K ●
- 3000K ●
- 3500K ●
- 4000K ●
- 5000K ●
- 2700-6000K ●
- 1800-4000K ○
- DTW 1800-3000K ○

Control

- Standard
- Non-standard
- ON/OFF ●
- DALI ●
- 0/1-10V ●
- TRIAC ●
- BLUETOOTH ○
- ZIGBEE ○
- CASAMBI ○

Optical Accessories

When E01 is selected, the protection level is IP20;
Choosing E02, E03, or E04 can achieve IP54 protection level;
You can choose one or both: E01+E02, E01+E03, or E01+E04.

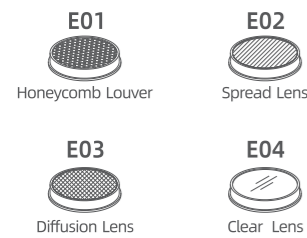

LED 5W/6.5W/8.5W (CITIZEN LED)

LED Power	System Power	LED Output	System Output	Beam	CCT	CRI	Drive
6W	7W	484lm	299lm	8°	3000K	> 90	12V 500mA
6.5W	7W	652lm	499lm	15°	3000K	> 90	32V 200mA
6.5W	8W	922lm	622lm	24°	3000K	> 90	34V 200mA
6.5W	8W	922lm	697lm	36°	3000K	> 90	34V 200mA
6.5W	8W	922lm	669lm	45°	3000K	> 90	34V 200mA
6.5W	8W	922lm	655lm	55°	3000K	> 90	34V 200mA
8W	9W	815lm	576lm	15°	3000K	> 90	32V 250mA
8.5W	10W	1067lm	760lm	24°	3000K	> 90	34V 250mA
8.5W	10W	1067lm	842lm	36°	3000K	> 90	34V 250mA
8.5W	10W	1067lm	828lm	45°	3000K	> 90	34V 250mA
8.5W	10W	1067lm	792lm	55°	3000K	> 90	34V 250mA

Light Distribution

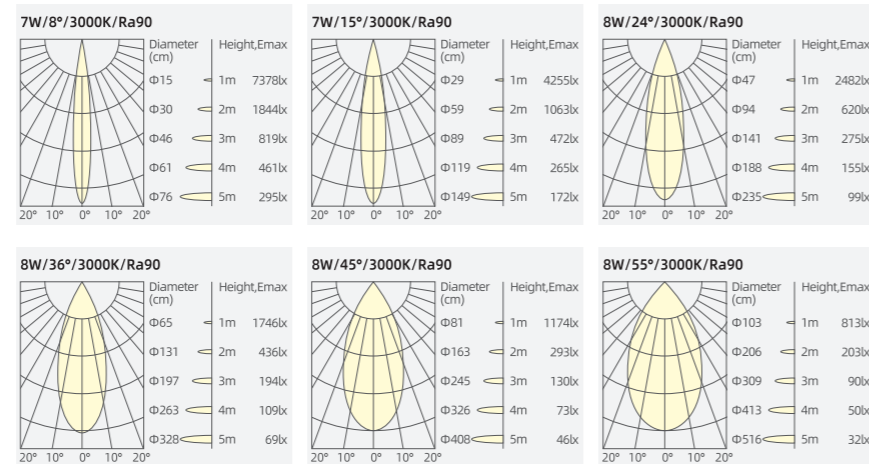

Colour(Reflector)

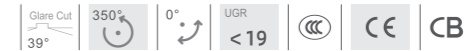

**MODERN
12540AD**

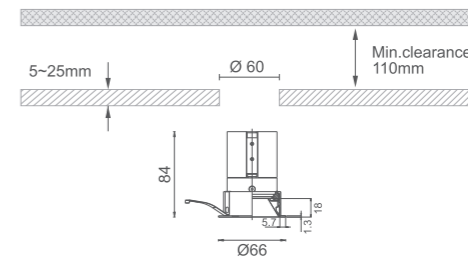

Colour(Front ring)

- Standard
- Non-standard
- WHITE ●
- BLACK ●

IP rate

- Standard
- Non-standard
- IP20 ●
- IP54 ●

CCT

- Standard
- Non-standard
- 2700K ●
- 3000K ●
- 3500K ●
- 4000K ●
- 5000K ●
- 2700-6000K ●
- 1800-4000K ○
- DTW 1800-3000K ○

Control

- Standard
- Non-standard
- ON/OFF ●
- DALI ●
- 0/1-10V ●
- TRIAC ●
- BLUETOOTH ○
- ZIGBEE ○
- CASAMBI ○

Optical Accessories

When E01 is selected, the protection level is IP20;
Choosing E02, E03, or E04 can achieve IP54 protection level;
You can choose one or both: E01+E02, E01+E03, or E01+E04.

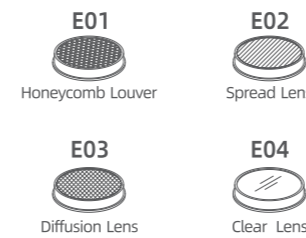

LED 5W/6.5W/8.5W (CITIZEN LED)

LED Power	System Power	LED Output	System Output	Beam	CCT	CRI	Drive
6W	7W	484lm	299lm	8°	3000K	> 90	12V 500mA
6.5W	7W	652lm	499lm	15°	3000K	> 90	32V 200mA
6.5W	8W	922lm	622lm	24°	3000K	> 90	34V 200mA
6.5W	8W	922lm	697lm	36°	3000K	> 90	34V 200mA
6.5W	8W	922lm	669lm	45°	3000K	> 90	34V 200mA
6.5W	8W	922lm	655lm	55°	3000K	> 90	34V 200mA
8W	9W	815lm	576lm	15°	3000K	> 90	32V 250mA
8.5W	10W	1067lm	760lm	24°	3000K	> 90	34V 250mA
8.5W	10W	1067lm	842lm	36°	3000K	> 90	34V 250mA
8.5W	10W	1067lm	828lm	45°	3000K	> 90	34V 250mA
8.5W	10W	1067lm	792lm	55°	3000K	> 90	34V 250mA

Light Distribution

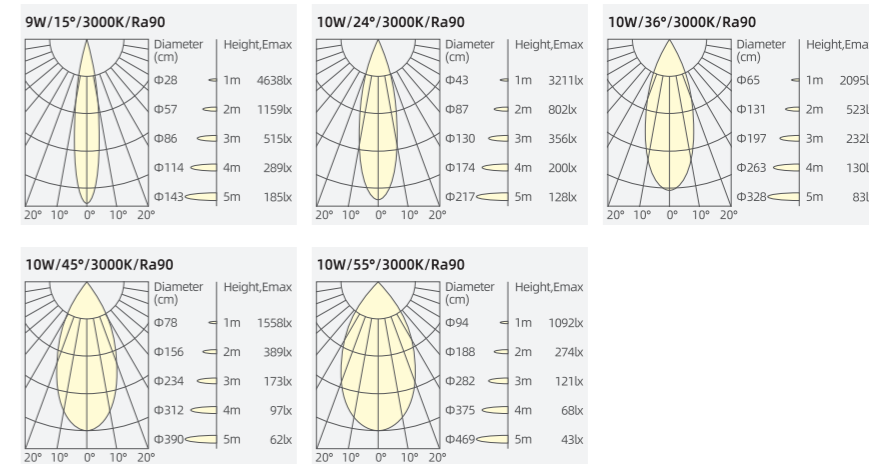

Colour(Reflector)





**MODERN
12541AW**

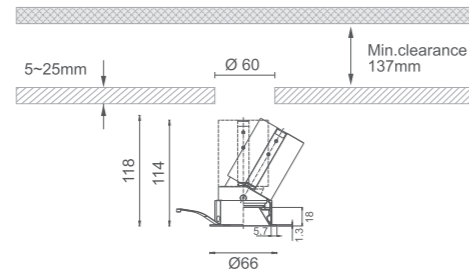

Colour(Front ring)

- Standard
- Non-standard
- WHITE
- BLACK

IP rate

- Standard
- Non-standard
- IP20
- IP54

CCT

- Standard
- Non-standard
- 2700K
- 3000K
- 3500K
- 4000K
- 5000K
- 2700-6000K
- 1800-4000K
- DTW 1800-3000K

Control

- Standard
- Non-standard
- ON/OFF
- DALI
- 0/1-10V
- TRIAC
- BLUETOOTH
- ZIGBEE
- CASAMBI

Optical Accessories

When E01 is selected, the protection level is IP20;
Choosing E02, E03, or E04 can achieve IP54 protection level;
You can choose one or both: E01+E02, E01+E03, or E01+E04.

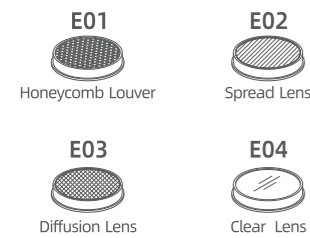

LED 10W/12W (CITIZEN LED)

LED Power	System Power	LED Output	System Output	Beam	CCT	CRI	Drive
9.5W	10.5W	951lm	639lm	15°	3000K	> 90	32V 300mA
10W	11.5W	1320lm	843lm	24°	3000K	> 90	34V 300mA
10W	11.5W	1320lm	976lm	36°	3000K	> 90	34V 300mA
10W	11.5W	1320lm	905lm	45°	3000K	> 90	34V 300mA
10W	11.5W	1320lm	885lm	55°	3000K	> 90	34V 300mA
11.5W	12.5W	1087lm	695lm	15°	3000K	> 90	32V 350mA
12W	14W	1650lm	1037lm	24°	3000K	> 90	34V 350mA
12W	14W	1650lm	1142lm	36°	3000K	> 90	34V 350mA
12W	14W	1650lm	1116lm	45°	3000K	> 90	34V 350mA
12W	14W	1650lm	1082lm	55°	3000K	> 90	34V 350mA

Light Distribution

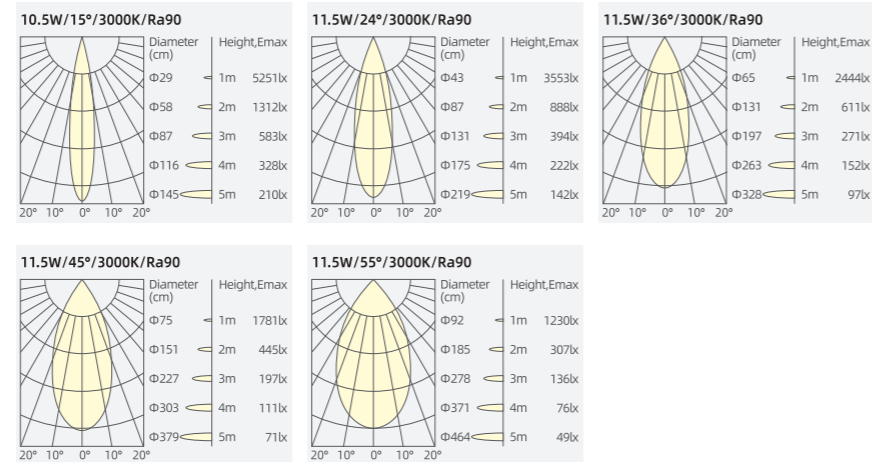

Colour(Reflector)



**MODERN
12541AD**

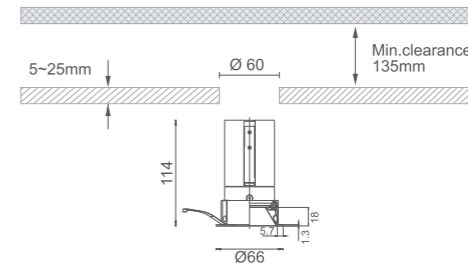

Colour(Front ring)

- Standard
- Non-standard
- WHITE
- BLACK

IP rate

- Standard
- Non-standard
- IP20
- IP54

CCT

- Standard
- Non-standard
- 2700K
- 3000K
- 3500K
- 4000K
- 5000K
- 2700-6000K
- 1800-4000K
- DTW 1800-3000K

Control

- Standard
- Non-standard
- ON/OFF
- DALI
- 0/1-10V
- TRIAC
- BLUETOOTH
- ZIGBEE
- CASAMBI

Optical Accessories

When E01 is selected, the protection level is IP20;
Choosing E02, E03, or E04 can achieve IP54 protection level;
You can choose one or both: E01+E02, E01+E03, or E01+E04.

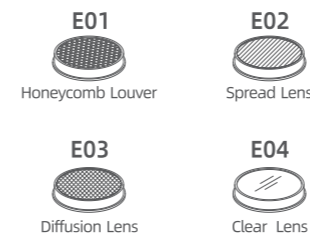

LED 10W/12W (CITIZEN LED)

LED Power	System Power	LED Output	System Output	Beam	CCT	CRI	Drive
9.5W	10.5W	951lm	639lm	15°	3000K	> 90	32V 300mA
10W	11.5W	1320lm	843lm	24°	3000K	> 90	34V 300mA
10W	11.5W	1320lm	976lm	36°	3000K	> 90	34V 300mA
10W	11.5W	1320lm	905lm	45°	3000K	> 90	34V 300mA
10W	11.5W	1320lm	885lm	55°	3000K	> 90	34V 300mA
11.5W	12.5W	1087lm	695lm	15°	3000K	> 90	32V 350mA
12W	14W	1650lm	1037lm	24°	3000K	> 90	34V 350mA
12W	14W	1650lm	1142lm	36°	3000K	> 90	34V 350mA
12W	14W	1650lm	1116lm	45°	3000K	> 90	34V 350mA
12W	14W	1650lm	1082lm	55°	3000K	> 90	34V 350mA

Light Distribution

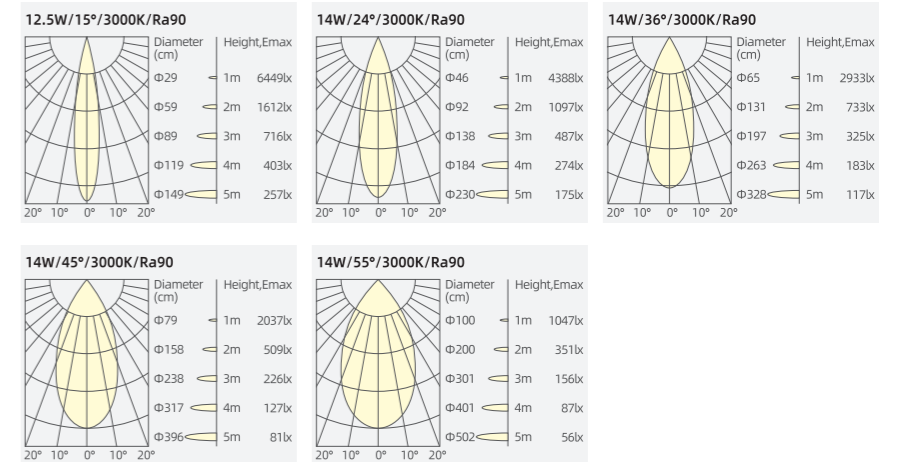

Colour(Reflector)





**MODERN
12542AW**

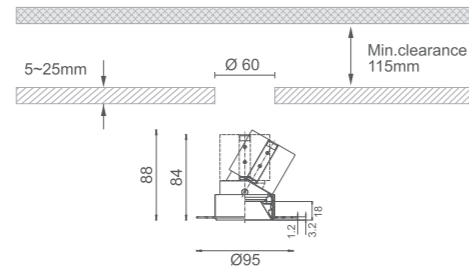

Colour(Front ring)

- Standard
- Non-standard
- WHITE ●
- BLACK ●

IP rate

- Standard
- Non-standard
- IP20 ●
- IP54 ●

CCT

- Standard
- Non-standard
- 2700K ●
- 3000K ●
- 3500K ●
- 4000K ●
- 5000K ●
- 2700-6000K ●
- 1800-4000K ○
- DTW 1800-3000K ○

Control

- Standard
- Non-standard
- ON/OFF ●
- DALI ●
- 0/1-10V ●
- TRIAC ●
- BLUETOOTH ○
- ZIGBEE ○
- CASAMBI ○

Optical Accessories

When E01 is selected, the protection level is IP20;
Choosing E02, E03, or E04 can achieve IP54 protection level;
You can choose one or both: E01+E02, E01+E03, or E01+E04.

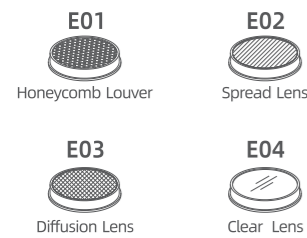

LED 5W/6.5W/8.5W (CITIZEN LED)

LED Power	System Power	LED Output	System Output	Beam	CCT	CRI	Drive
6W	7W	484lm	299lm	8°	3000K	> 90	12V 500mA
6.5W	7W	652lm	499lm	15°	3000K	> 90	32V 200mA
6.5W	8W	922lm	622lm	24°	3000K	> 90	34V 200mA
6.5W	8W	922lm	697lm	36°	3000K	> 90	34V 200mA
6.5W	8W	922lm	669lm	45°	3000K	> 90	34V 200mA
6.5W	8W	922lm	655lm	55°	3000K	> 90	34V 200mA
8W	9W	815lm	576lm	15°	3000K	> 90	32V 250mA
8.5W	10W	1067lm	760lm	24°	3000K	> 90	34V 250mA
8.5W	10W	1067lm	842lm	36°	3000K	> 90	34V 250mA
8.5W	10W	1067lm	828lm	45°	3000K	> 90	34V 250mA
8.5W	10W	1067lm	792lm	55°	3000K	> 90	34V 250mA

Light Distribution

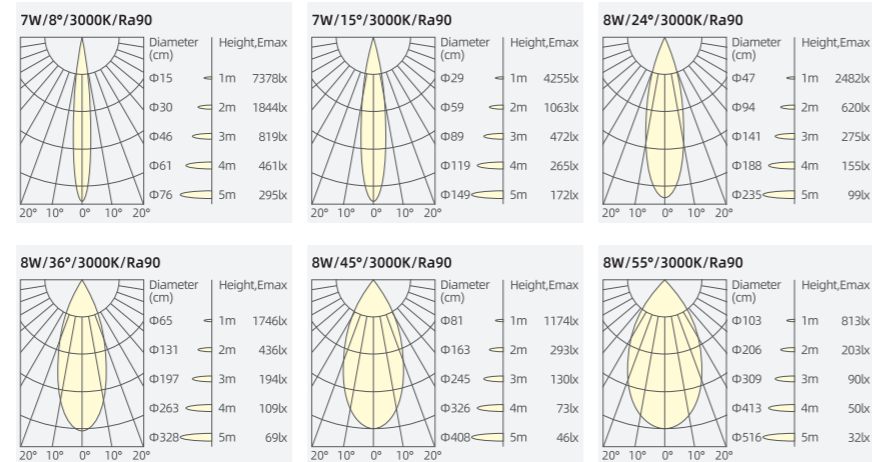

Colour(Reflector)



**MODERN
12542AD**

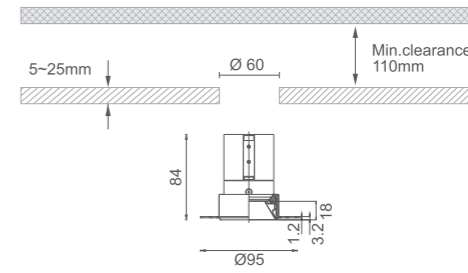

Colour(Front ring)

- Standard
- Non-standard
- WHITE ●
- BLACK ●

IP rate

- Standard
- Non-standard
- IP20 ●
- IP54 ●

CCT

- Standard
- Non-standard
- 2700K ●
- 3000K ●
- 3500K ●
- 4000K ●
- 5000K ●
- 2700-6000K ●
- 1800-4000K ○
- DTW 1800-3000K ○

Control

- Standard
- Non-standard
- ON/OFF ●
- DALI ●
- 0/1-10V ●
- TRIAC ●
- BLUETOOTH ○
- ZIGBEE ○
- CASAMBI ○

Optical Accessories

When E01 is selected, the protection level is IP20;
Choosing E02, E03, or E04 can achieve IP54 protection level;
You can choose one or both: E01+E02, E01+E03, or E01+E04.

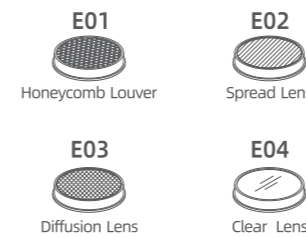

LED 5W/6.5W/8.5W (CITIZEN LED)

LED Power	System Power	LED Output	System Output	Beam	CCT	CRI	Drive
6W	7W	484lm	299lm	8°	3000K	> 90	12V 500mA
6.5W	7W	652lm	499lm	15°	3000K	> 90	32V 200mA
6.5W	8W	922lm	622lm	24°	3000K	> 90	34V 200mA
6.5W	8W	922lm	697lm	36°	3000K	> 90	34V 200mA
6.5W	8W	922lm	669lm	45°	3000K	> 90	34V 200mA
6.5W	8W	922lm	655lm	55°	3000K	> 90	34V 200mA
8W	9W	815lm	576lm	15°	3000K	> 90	32V 250mA
8.5W	10W	1067lm	760lm	24°	3000K	> 90	34V 250mA
8.5W	10W	1067lm	842lm	36°	3000K	> 90	34V 250mA
8.5W	10W	1067lm	828lm	45°	3000K	> 90	34V 250mA
8.5W	10W	1067lm	792lm	55°	3000K	> 90	34V 250mA

Light Distribution

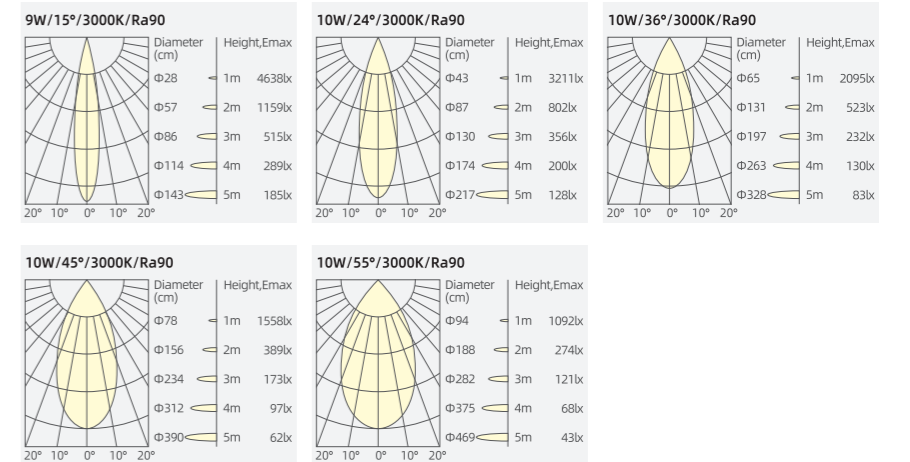

Colour(Reflector)





**MODERN
12543AW**

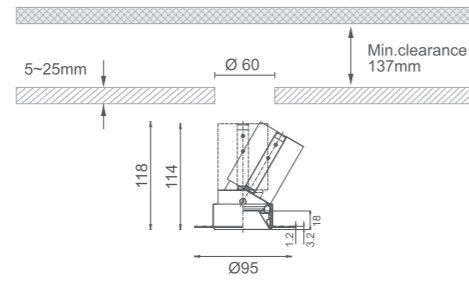

Colour(Front ring)

- Standard
- Non-standard
- WHITE
- BLACK

IP rate

- Standard
- Non-standard
- IP20
- IP54

CCT

- Standard
- Non-standard
- 2700K
- 3000K
- 3500K
- 4000K
- 5000K
- 2700-6000K
- 1800-4000K
- DTW 1800-3000K

Control

- Standard
- Non-standard
- ON/OFF
- DALI
- 0/1-10V
- TRIAC
- BLUETOOTH
- ZIGBEE
- CASAMBI

Optical Accessories

When E01 is selected, the protection level is IP20;
Choosing E02, E03, or E04 can achieve IP54 protection level;
You can choose one or both: E01+E02, E01+E03, or E01+E04.

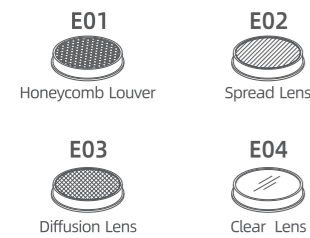

LED 9.5W/11.5W (CITIZEN LED)

LED Power	System Power	LED Output	System Output	Beam	CCT	CRI	Drive
9.5W	10.5W	951lm	639lm	15°	3000K	> 90	32V 300mA
10W	11.5W	1320lm	843lm	24°	3000K	> 90	34V 300mA
10W	11.5W	1320lm	976lm	36°	3000K	> 90	34V 300mA
10W	11.5W	1320lm	905lm	45°	3000K	> 90	34V 300mA
10W	11.5W	1320lm	885lm	55°	3000K	> 90	34V 300mA
11.5W	12.5W	1087lm	695lm	15°	3000K	> 90	32V 350mA
12W	14W	1650lm	1037lm	24°	3000K	> 90	34V 350mA
12W	14W	1650lm	1142lm	36°	3000K	> 90	34V 350mA
12W	14W	1650lm	1116lm	45°	3000K	> 90	34V 350mA
12W	14W	1650lm	1082lm	55°	3000K	> 90	34V 350mA

Light Distribution

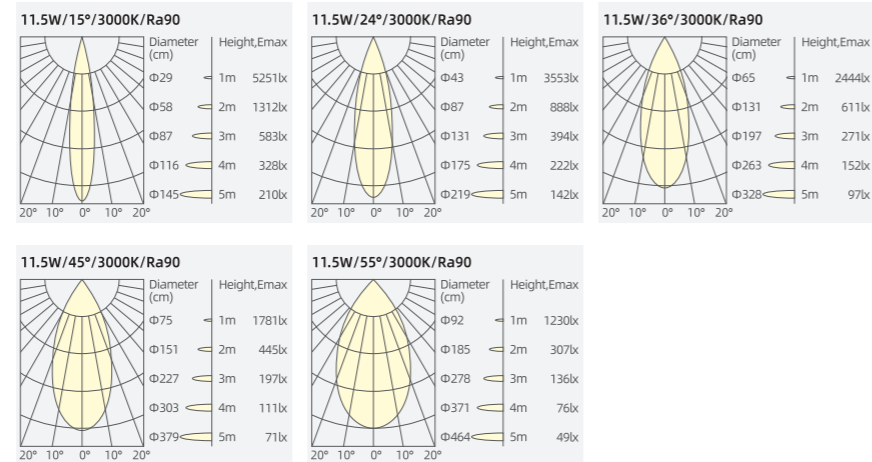

Colour(Reflector)



**MODERN
12543AD**

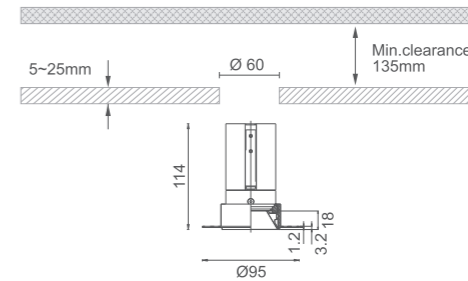

Colour(Front ring)

- Standard
- Non-standard
- WHITE
- BLACK

IP rate

- Standard
- Non-standard
- IP20
- IP54

CCT

- Standard
- Non-standard
- 2700K
- 3000K
- 3500K
- 4000K
- 5000K
- 2700-6000K
- 1800-4000K
- DTW 1800-3000K

Control

- Standard
- Non-standard
- ON/OFF
- DALI
- 0/1-10V
- TRIAC
- BLUETOOTH
- ZIGBEE
- CASAMBI

Optical Accessories

When E01 is selected, the protection level is IP20;
Choosing E02, E03, or E04 can achieve IP54 protection level;
You can choose one or both: E01+E02, E01+E03, or E01+E04.

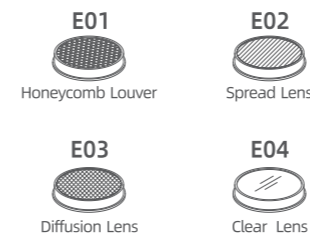

LED 9.5W/11.5W (CITIZEN LED)

LED Power	System Power	LED Output	System Output	Beam	CCT	CRI	Drive
9.5W	10.5W	951lm	639lm	15°	3000K	> 90	32V 300mA
10.5W	11.5W	1320lm	843lm	24°	3000K	> 90	34V 300mA
10.5W	11.5W	1320lm	976lm	36°	3000K	> 90	34V 300mA
10.5W	11.5W	1320lm	905lm	45°	3000K	> 90	34V 300mA
10.5W	11.5W	1320lm	885lm	55°	3000K	> 90	34V 300mA
11.5W	12.5W	1087lm	695lm	15°	3000K	> 90	32V 350mA
12W	14W	1650lm	1037lm	24°	3000K	> 90	34V 350mA
12W	14W	1650lm	1142lm	36°	3000K	> 90	34V 350mA
12W	14W	1650lm	1116lm	45°	3000K	> 90	34V 350mA
12W	14W	1650lm	1082lm	55°	3000K	> 90	34V 350mA

Light Distribution

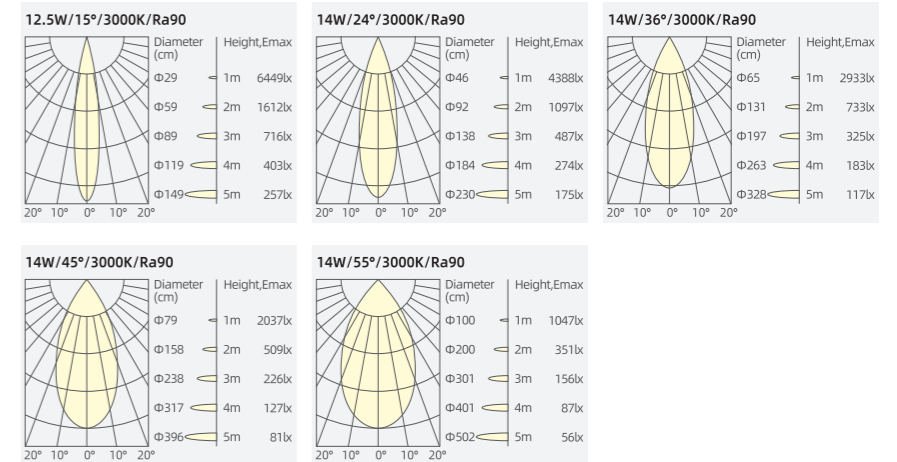

Colour(Reflector)





**MODERN
12550AW**

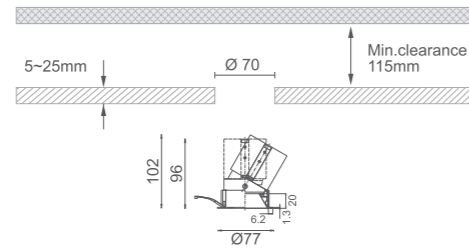

Colour(Front ring)

- Standard
- Non-standard
- WHITE
- BLACK

IP rate

- Standard
- Non-standard
- IP20
- IP54

CCT

- Standard
- Non-standard
- 2700K
- 3000K
- 3500K
- 4000K
- 5000K
- 2700-6000K
- 1800-4000K
- DTW 1800-3000K
- RGBCW

Control

- Standard
- Non-standard
- ON/OFF
- DALI
- 0/1-10V
- TRIAC
- BLUETOOTH
- ZIGBEE
- CASAMBI

Optical Accessories

When E01 is selected, the protection level is IP20;
Choosing E02, E03, or E04 can achieve IP54 protection level;
You can choose one or both: E01+E02, E01+E03, or E01+E04.

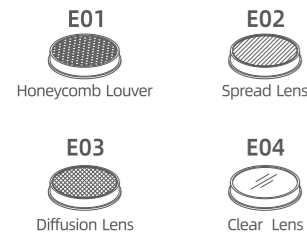

LED 8.5W/10W (CITIZEN LED)

LED Power	System Power	LED Output	System Output	Beam	CCT	CRI	Drive
6W	7W	484lm	352lm	6°	3000K	> 90	12V 500mA
9W	11W	792lm	540lm	10°	3000K	> 90	36V 250mA
8W	9W	951lm	669lm	15°	3000K	> 90	32V 250mA
8.5W	10W	1067lm	907lm	24°	3000K	> 90	34V 250mA
8.5W	10W	1067lm	944lm	36°	3000K	> 90	34V 250mA
8.5W	10W	1067lm	931lm	45°	3000K	> 90	34V 250mA
8.5W	10W	1067lm	932lm	55°	3000K	> 90	34V 250mA
10.5W	12W	946lm	654lm	10°	3000K	> 90	36V 300mA
9.5W	10.5W	1087lm	724lm	15°	3000K	> 90	32V 300mA
10W	11.5W	1320lm	1032lm	24°	3000K	> 90	34V 300mA
10W	11.5W	1320lm	1080lm	36°	3000K	> 90	34V 300mA
10W	11.5W	1320lm	1089lm	45°	3000K	> 90	34V 300mA
10W	11.5W	1320lm	1064lm	55°	3000K	> 90	34V 300mA

Light Distribution

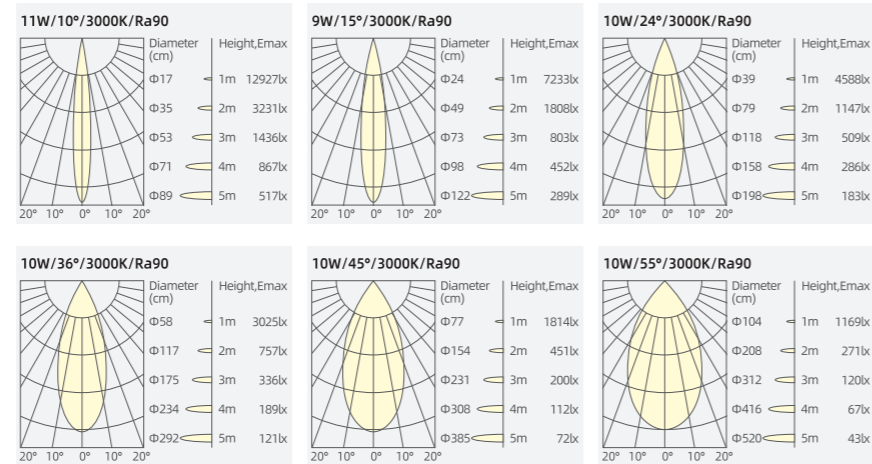

Colour(Reflector)



**MODERN
12550AD**

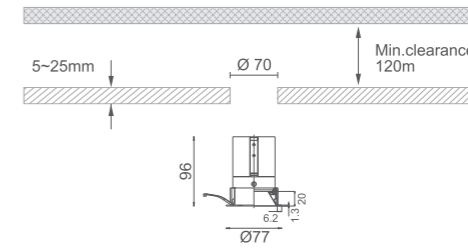

Colour(Front ring)

- Standard
- Non-standard
- WHITE
- BLACK

IP rate

- Standard
- Non-standard
- IP20
- IP54

CCT

- Standard
- Non-standard
- 2700K
- 3000K
- 3500K
- 4000K
- 5000K
- 2700-6000K
- 1800-4000K
- DTW 1800-3000K
- RGBCW

Control

- Standard
- Non-standard
- ON/OFF
- DALI
- 0/1-10V
- TRIAC
- BLUETOOTH
- ZIGBEE
- CASAMBI

Optical Accessories

When E01 is selected, the protection level is IP20;
Choosing E02, E03, or E04 can achieve IP54 protection level;
You can choose one or both: E01+E02, E01+E03, or E01+E04.

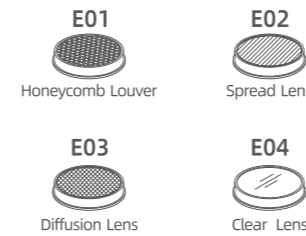

LED 8.5W/10W (CITIZEN LED)

LED Power	System Power	LED Output	System Output	Beam	CCT	CRI	Drive
6W	7W	484lm	352lm	6°	3000K	> 90	12V 500mA
9W	11W	792lm	540lm	10°	3000K	> 90	36V 250mA
8W	9W	951lm	669lm	15°	3000K	> 90	32V 250mA
8.5W	10W	1067lm	907lm	24°	3000K	> 90	34V 250mA
8.5W	10W	1067lm	944lm	36°	3000K	> 90	34V 250mA
8.5W	10W	1067lm	931lm	45°	3000K	> 90	34V 250mA
8.5W	10W	1067lm	932lm	55°	3000K	> 90	34V 250mA
10.5W	12W	946lm	654lm	10°	3000K	> 90	36V 300mA
9.5W	10.5W	1087lm	724lm	15°	3000K	> 90	32V 300mA
10W	11.5W	1320lm	1032lm	24°	3000K	> 90	34V 300mA
10W	11.5W	1320lm	1080lm	36°	3000K	> 90	34V 300mA
10W	11.5W	1320lm	1089lm	45°	3000K	> 90	34V 300mA
10W	11.5W	1320lm	1064lm	55°	3000K	> 90	34V 300mA

Light Distribution

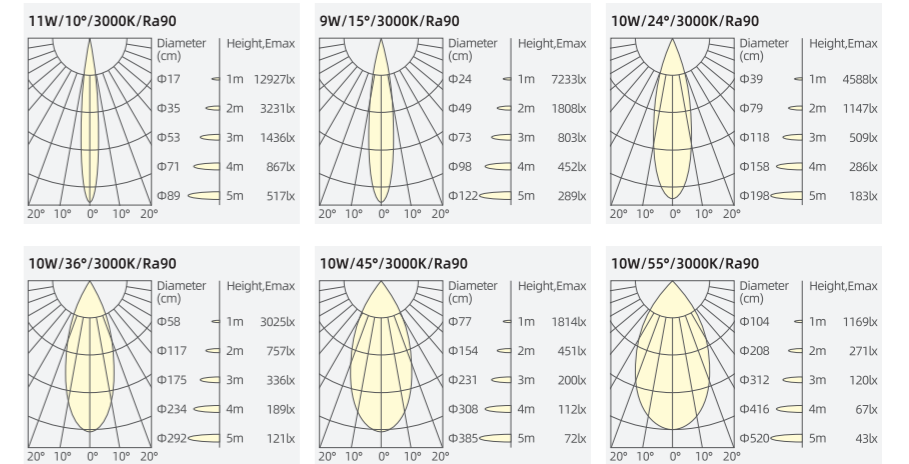

Colour(Reflector)



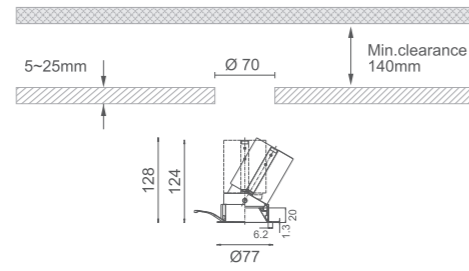

**MODERN
12551AW**

Colour(Front ring)

- Standard
- Non-standard
- WHITE
- BLACK

IP rate

- Standard
- Non-standard
- IP20
- IP54

CCT

- Standard
- Non-standard
- 2700K
- 3000K
- 3500K
- 4000K
- 5000K
- 2700-6000K
- 1800-4000K
- DTW 1800-3000K
- RGBCW

Control

- Standard
- Non-standard
- ON/OFF
- DALI
- 0/1-10V
- TRIAC
- BLUETOOTH
- ZIGBEE
- CASAMBI

Optical Accessories

When E01 is selected, the protection level is IP20;
Choosing E02, E03, or E04 can achieve IP54 protection level;
You can choose one or both: E01+E02, E01+E03, or E01+E04.

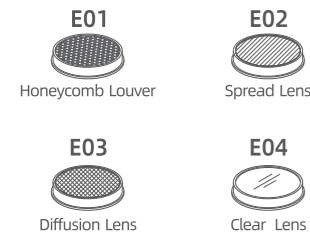

LED 12W/18W (CITIZEN LED)

LED Power	System Power	LED Output	System Output	Beam	CCT	CRI	Drive
12.5W	14.5W	946lm	697lm	10°	3000K	> 90	36V 350mA
11W	12.5W	1087lm	858lm	15°	3000K	> 90	32V 350mA
12W	14W	1650lm	1263lm	24°	3000K	> 90	34V 350mA
12W	14W	1650lm	1321lm	36°	3000K	> 90	34V 350mA
12W	14W	1650lm	1310lm	45°	3000K	> 90	34V 350mA
12W	14W	1650lm	1312lm	55°	3000K	> 90	34V 350mA
18W	20W	1926lm	1207lm	15°	3000K	> 90	34V 500mA
18W	20W	2343lm	1741lm	24°	3000K	> 90	34V 500mA
18W	20W	2343lm	1869lm	36°	3000K	> 90	34V 500mA
18W	20W	2343lm	1850lm	45°	3000K	> 90	34V 500mA
18W	20W	2343lm	1821lm	55°	3000K	> 90	34V 500mA

Light Distribution

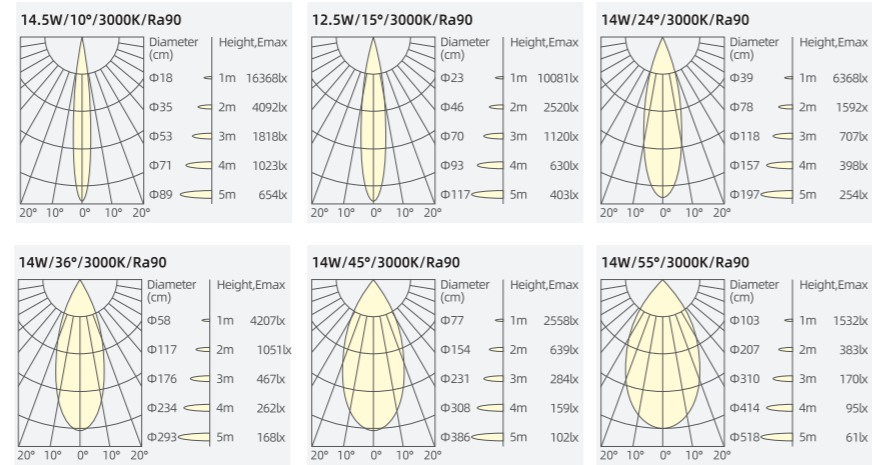

Colour(Reflector)

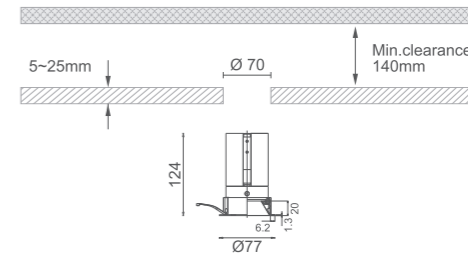

**MODERN
12551AD**

Colour(Front ring)

- Standard
- Non-standard
- WHITE
- BLACK

IP rate

- Standard
- Non-standard
- IP20
- IP54

CCT

- Standard
- Non-standard
- 2700K
- 3000K
- 3500K
- 4000K
- 5000K
- 2700-6000K
- 1800-4000K
- DTW 1800-3000K
- RGBCW

Control

- Standard
- Non-standard
- ON/OFF
- DALI
- 0/1-10V
- TRIAC
- BLUETOOTH
- ZIGBEE
- CASAMBI

Optical Accessories

When E01 is selected, the protection level is IP20;
Choosing E02, E03, or E04 can achieve IP54 protection level;
You can choose one or both: E01+E02, E01+E03, or E01+E04.

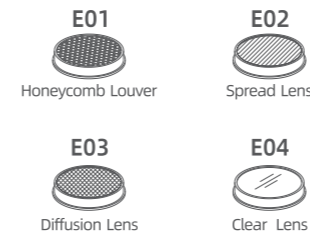

LED 12W/18W (CITIZEN LED)

LED Power	System Power	LED Output	System Output	Beam	CCT	CRI	Drive
12.5W	14.5W	946lm	697lm	10°	3000K	> 90	36V 350mA
11W	12.5W	1087lm	858lm	15°	3000K	> 90	32V 350mA
12W	14W	1650lm	1263lm	24°	3000K	> 90	34V 350mA
12W	14W	1650lm	1321lm	36°	3000K	> 90	34V 350mA
12W	14W	1650lm	1310lm	45°	3000K	> 90	34V 350mA
12W	14W	1650lm	1312lm	55°	3000K	> 90	34V 350mA
18W	20W	1926lm	1207lm	15°	3000K	> 90	34V 500mA
18W	20W	2343lm	1741lm	24°	3000K	> 90	34V 500mA
18W	20W	2343lm	1869lm	36°	3000K	> 90	34V 500mA
18W	20W	2343lm	1850lm	45°	3000K	> 90	34V 500mA
18W	20W	2343lm	1821lm	55°	3000K	> 90	34V 500mA

Light Distribution

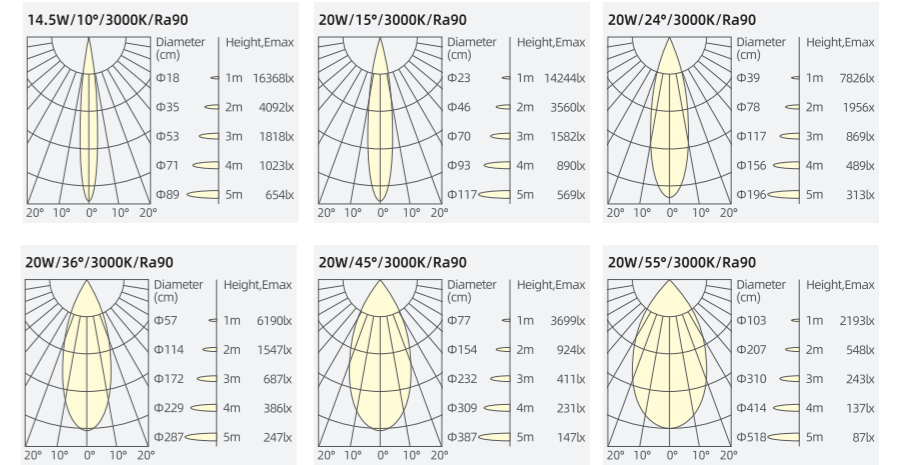

Colour(Reflector)





Glare Cut 350° 30° UGR <19

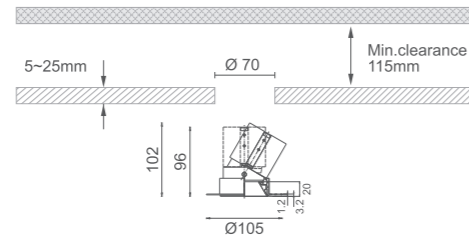

**MODERN
12552AW**

Colour(Front ring)

- Standard
- Non-standard
- WHITE ●
- BLACK ●

IP rate

- Standard
- Non-standard
- IP20 ●
- IP54 ●

CCT

- Standard
- Non-standard
- 2700K ●
- 3000K ●
- 3500K ●
- 4000K ●
- 5000K ●
- 2700-6000K ●
- 1800-4000K ○
- DTW 1800-3000K ○
- RGBCW ○

Control

- Standard
- Non-standard
- ON/OFF ●
- DALI ●
- 0/1-10V ●
- TRIAC ●
- BLUETOOTH ○
- ZIGBEE ○
- CASAMBI ○

Optical Accessories

When E01 is selected, the protection level is IP20;
Choosing E02, E03, or E04 can achieve IP54 protection level;
You can choose one or both: E01+E02, E01+E03, or E01+E04.

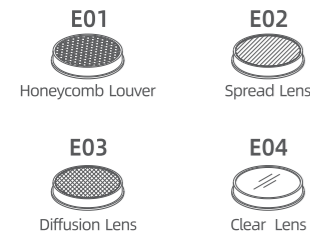

LED 8.5W/10W (CITIZEN LED)

LED Power	System Power	LED Output	System Output	Beam	CCT	CRI	Drive
6W	7W	484lm	352lm	6°	3000K	> 90	12V 500mA
9W	11W	792lm	540lm	10°	3000K	> 90	36V 250mA
8W	9W	951lm	669lm	15°	3000K	> 90	32V 250mA
8.5W	10W	1067lm	907lm	24°	3000K	> 90	34V 250mA
8.5W	10W	1067lm	944lm	36°	3000K	> 90	34V 250mA
8.5W	10W	1067lm	931lm	45°	3000K	> 90	34V 250mA
8.5W	10W	1067lm	932lm	55°	3000K	> 90	34V 250mA
10.5W	12W	946lm	654lm	10°	3000K	> 90	36V 300mA
9.5W	10.5W	1087lm	724lm	15°	3000K	> 90	32V 300mA
10W	11.5W	1320lm	1032lm	24°	3000K	> 90	34V 300mA
10W	11.5W	1320lm	1080lm	36°	3000K	> 90	34V 300mA
10W	11.5W	1320lm	1089lm	45°	3000K	> 90	34V 300mA
10W	11.5W	1320lm	1064lm	55°	3000K	> 90	34V 300mA

Light Distribution

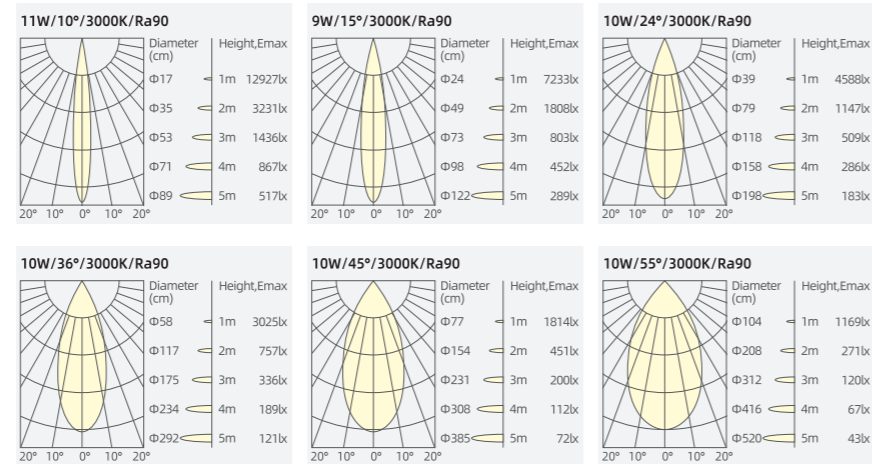

Colour(Reflector)



Glare Cut 350° 0° UGR <19

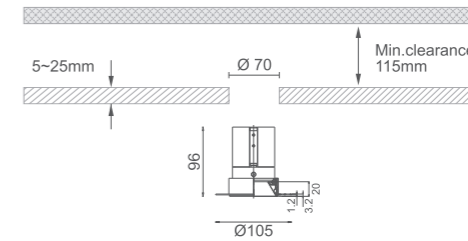

**MODERN
12552AD**

Colour(Front ring)

- Standard
- Non-standard
- WHITE ●
- BLACK ●

IP rate

- Standard
- Non-standard
- IP20 ●
- IP54 ●

CCT

- Standard
- Non-standard
- 2700K ●
- 3000K ●
- 3500K ●
- 4000K ●
- 5000K ●
- 2700-6000K ●
- 1800-4000K ○
- DTW 1800-3000K ○
- RGBCW ○

Control

- Standard
- Non-standard
- ON/OFF ●
- DALI ●
- 0/1-10V ●
- TRIAC ●
- BLUETOOTH ○
- ZIGBEE ○
- CASAMBI ○

Optical Accessories

When E01 is selected, the protection level is IP20;
Choosing E02, E03, or E04 can achieve IP54 protection level;
You can choose one or both: E01+E02, E01+E03, or E01+E04.

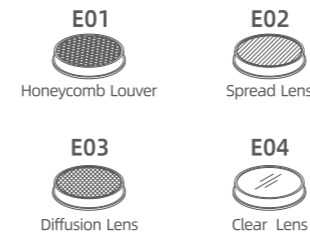

LED 8.5W/10W (CITIZEN LED)

LED Power	System Power	LED Output	System Output	Beam	CCT	CRI	Drive
6W	7W	484lm	352lm	6°	3000K	> 90	12V 500mA
9W	11W	792lm	540lm	10°	3000K	> 90	36V 250mA
8W	9W	951lm	669lm	15°	3000K	> 90	32V 250mA
8.5W	10W	1067lm	907lm	24°	3000K	> 90	34V 250mA
8.5W	10W	1067lm	944lm	36°	3000K	> 90	34V 250mA
8.5W	10W	1067lm	931lm	45°	3000K	> 90	34V 250mA
8.5W	10W	1067lm	932lm	55°	3000K	> 90	34V 250mA
10.5W	12W	946lm	654lm	10°	3000K	> 90	36V 300mA
9.5W	10.5W	1087lm	724lm	15°	3000K	> 90	32V 300mA
10W	11.5W	1320lm	1032lm	24°	3000K	> 90	34V 300mA
10W	11.5W	1320lm	1080lm	36°	3000K	> 90	34V 300mA
10W	11.5W	1320lm	1089lm	45°	3000K	> 90	34V 300mA
10W	11.5W	1320lm	1064lm	55°	3000K	> 90	34V 300mA

Light Distribution

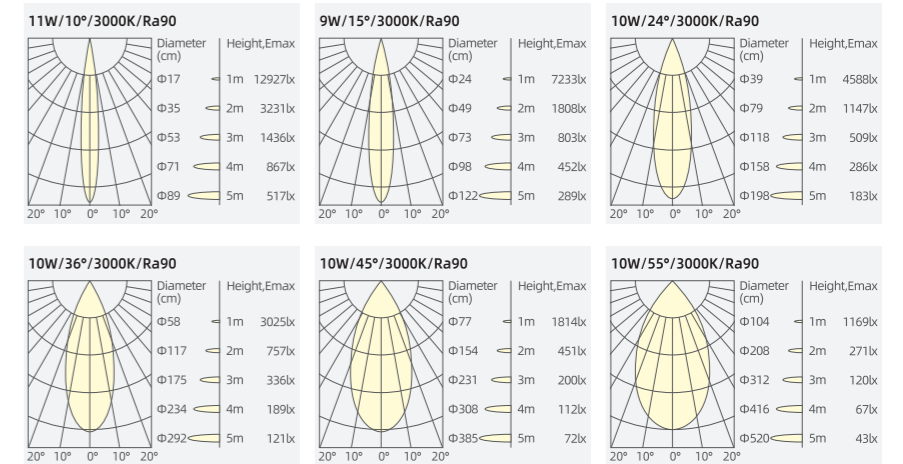

Colour(Reflector)





**MODERN
12553AW**

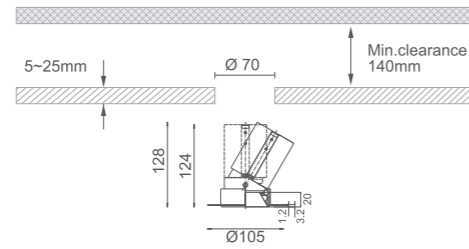

Colour(Front ring)

- Standard
- Non-standard
- WHITE ●
- BLACK ●

IP rate

- Standard
- Non-standard
- IP20 ●
- IP54 ●

CCT

- Standard
- Non-standard
- 2700K ●
- 3000K ●
- 3500K ●
- 4000K ●
- 5000K ●
- 2700-6000K ●
- 1800-4000K ○
- DTW 1800-3000K ○
- RGBCW ○

Control

- Standard
- Non-standard
- ON/OFF ●
- DALI ●
- 0/1-10V ●
- TRIAC ●
- BLUETOOTH ○
- ZIGBEE ○
- CASAMBI ○

Optical Accessories

When E01 is selected, the protection level is IP20;
Choosing E02, E03, or E04 can achieve IP54 protection level;
You can choose one or both: E01+E02, E01+E03, or E01+E04.

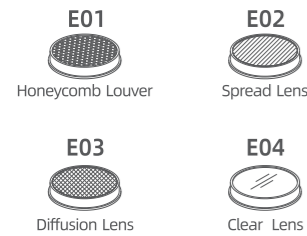

LED 12W/18W (CITIZEN LED)

LED Power	System Power	LED Output	System Output	Beam	CCT	CRI	Drive
12.5W	14.5W	946lm	697lm	10°	3000K	>90	36V 350mA
11W	12.5W	1087lm	858lm	15°	3000K	>90	32V 350mA
12W	14W	1650lm	1263lm	24°	3000K	>90	34V 350mA
12W	14W	1650lm	1321lm	36°	3000K	>90	34V 350mA
12W	14W	1650lm	1310lm	45°	3000K	>90	34V 350mA
12W	14W	1650lm	1312lm	55°	3000K	>90	34V 350mA
18W	20W	1926lm	1207lm	15°	3000K	>90	34V 500mA
18W	20W	2343lm	1741lm	24°	3000K	>90	34V 500mA
18W	20W	2343lm	1869lm	36°	3000K	>90	34V 500mA
18W	20W	2343lm	1850lm	45°	3000K	>90	34V 500mA
18W	20W	2343lm	1821lm	55°	3000K	>90	34V 500mA

Light Distribution

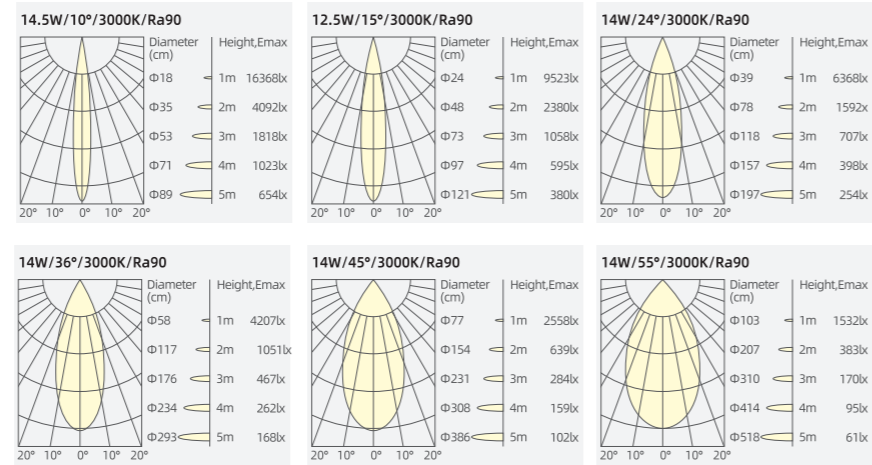

Colour(Reflector)



**MODERN
12553AD**

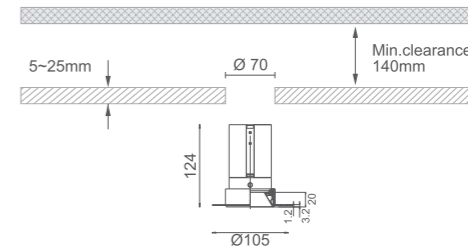

Colour(Front ring)

- Standard
- Non-standard
- WHITE ●
- BLACK ●

IP rate

- Standard
- Non-standard
- IP20 ●
- IP54 ●

CCT

- Standard
- Non-standard
- 2700K ●
- 3000K ●
- 3500K ●
- 4000K ●
- 5000K ●
- 2700-6000K ●
- 1800-4000K ○
- DTW 1800-3000K ○
- RGBCW ○

Control

- Standard
- Non-standard
- ON/OFF ●
- DALI ●
- 0/1-10V ●
- TRIAC ●
- BLUETOOTH ○
- ZIGBEE ○
- CASAMBI ○

Optical Accessories

When E01 is selected, the protection level is IP20;
Choosing E02, E03, or E04 can achieve IP54 protection level;
You can choose one or both: E01+E02, E01+E03, or E01+E04.

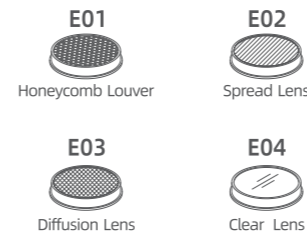

LED 12W/18W (CITIZEN LED)

LED Power	System Power	LED Output	System Output	Beam	CCT	CRI	Drive
12.5W	14.5W	946lm	697lm	10°	3000K	>90	36V 350mA
11W	12.5W	1087lm	858lm	15°	3000K	>90	32V 350mA
12W	14W	1650lm	1263lm	24°	3000K	>90	34V 350mA
12W	14W	1650lm	1321lm	36°	3000K	>90	34V 350mA
12W	14W	1650lm	1310lm	45°	3000K	>90	34V 350mA
12W	14W	1650lm	1312lm	55°	3000K	>90	34V 350mA
18W	20W	1926lm	1207lm	15°	3000K	>90	34V 500mA
18W	20W	2343lm	1741lm	24°	3000K	>90	34V 500mA
18W	20W	2343lm	1869lm	36°	3000K	>90	34V 500mA
18W	20W	2343lm	1850lm	45°	3000K	>90	34V 500mA
18W	20W	2343lm	1821lm	55°	3000K	>90	34V 500mA

Light Distribution

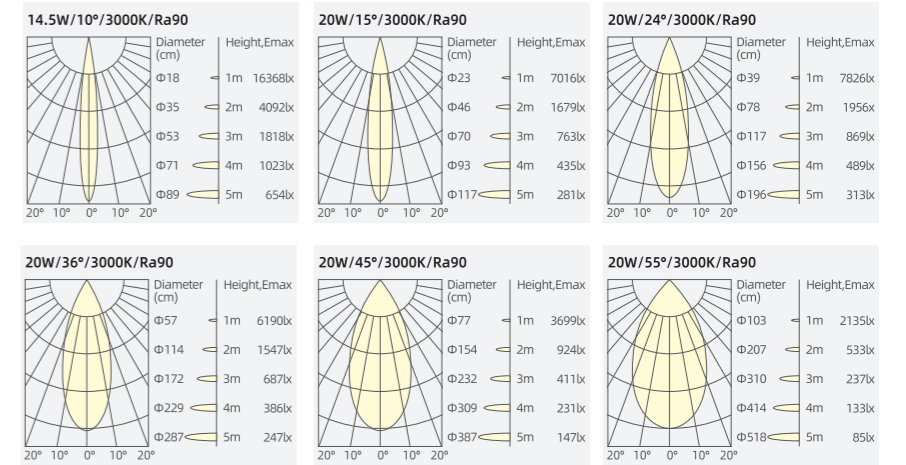

Colour(Reflector)





Glare Cut 37° 350° 25° UGR < 19

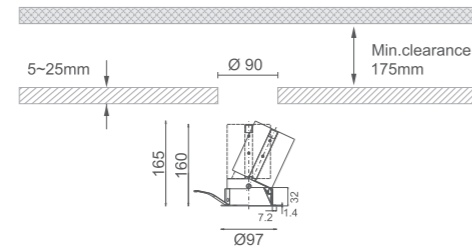

MODERN 12560AW

Colour(Front ring)

- Standard
- Non-standard
- WHITE
- BLACK

IP rate

- Standard
- Non-standard
- IP20
- IP54

CCT

- Standard
- Non-standard
- 2700K
- 3000K
- 3500K
- 4000K
- 5000K
- 2700-6000K
- 1800-4000K
- DTW 1800-3000K
- RGBCW

Control

- Standard
- Non-standard
- ON/OFF
- DALI
- 0/1-10V
- TRIAC
- BLUETOOTH
- ZIGBEE
- CASAMBI

Optical Accessories

When E01 is selected, the protection level is IP20;
Choosing E02, E03, or E04 can achieve IP54 protection level;
You can choose one or both: E01+E02, E01+E03, or E01+E04.

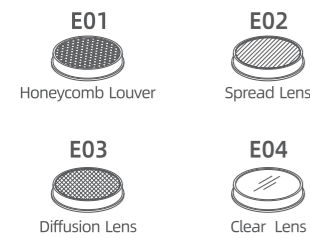

LED 24W/30.5W (CITIZEN LED)

LED Power	System Power	LED Output	System Output	Beam	CCT	CRI	Drive
24W	27.5W	2939lm	1806lm	15°	3000K	> 90	34V 700mA
24W	27.5W	3066lm	2248lm	24°	3000K	> 90	34V 700mA
24W	27.5W	3066lm	2435lm	36°	3000K	> 90	34V 700mA
24W	27.5W	3066lm	2430lm	45°	3000K	> 90	34V 700mA
24W	27.5W	3066lm	2333lm	55°	3000K	> 90	34V 700mA
30.5W	36W	3285lm	1950lm	15°	3000K	> 90	34V 900mA
30.5W	36W	3960lm	2837lm	24°	3000K	> 90	34V 900mA
30.5W	36W	3960lm	2941lm	36°	3000K	> 90	34V 900mA
30.5W	36W	3960lm	2874lm	45°	3000K	> 90	34V 900mA
30.5W	36W	3960lm	2773lm	55°	3000K	> 90	34V 900mA

Light Distribution

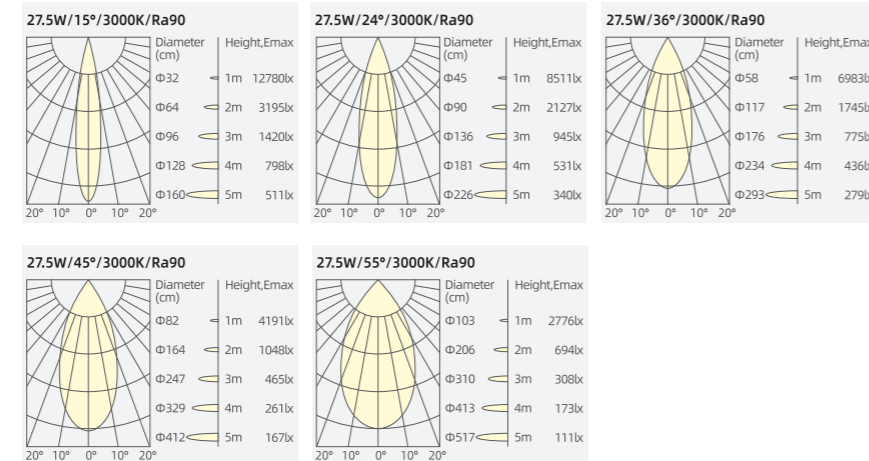

Colour(Reflector)



Glare Cut 37° 350° 0° UGR < 19

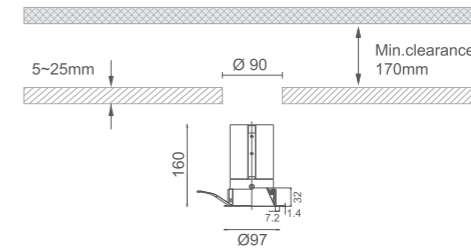

MODERN 12560AD

Colour(Front ring)

- Standard
- Non-standard
- WHITE
- BLACK

IP rate

- Standard
- Non-standard
- IP20
- IP54

CCT

- Standard
- Non-standard
- 2700K
- 3000K
- 3500K
- 4000K
- 5000K
- 2700-6000K
- 1800-4000K
- DTW 1800-3000K
- RGBCW

Control

- Standard
- Non-standard
- ON/OFF
- DALI
- 0/1-10V
- TRIAC
- BLUETOOTH
- ZIGBEE
- CASAMBI

Optical Accessories

When E01 is selected, the protection level is IP20;
Choosing E02, E03, or E04 can achieve IP54 protection level;
You can choose one or both: E01+E02, E01+E03, or E01+E04.

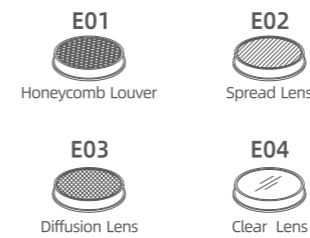

LED 24W/30.5W (CITIZEN LED)

LED Power	System Power	LED Output	System Output	Beam	CCT	CRI	Drive
24W	27.5W	2939lm	1806lm	15°	3000K	> 90	34V 700mA
24W	27.5W	3066lm	2248lm	24°	3000K	> 90	34V 700mA
24W	27.5W	3066lm	2435lm	36°	3000K	> 90	34V 700mA
24W	27.5W	3066lm	2430lm	45°	3000K	> 90	34V 700mA
24W	27.5W	3066lm	2333lm	55°	3000K	> 90	34V 700mA
30.5W	36W	3285lm	1950lm	15°	3000K	> 90	34V 900mA
30.5W	36W	3960lm	2837lm	24°	3000K	> 90	34V 900mA
30.5W	36W	3960lm	2941lm	36°	3000K	> 90	34V 900mA
30.5W	36W	3960lm	2874lm	45°	3000K	> 90	34V 900mA
30.5W	36W	3960lm	2773lm	55°	3000K	> 90	34V 900mA

Light Distribution

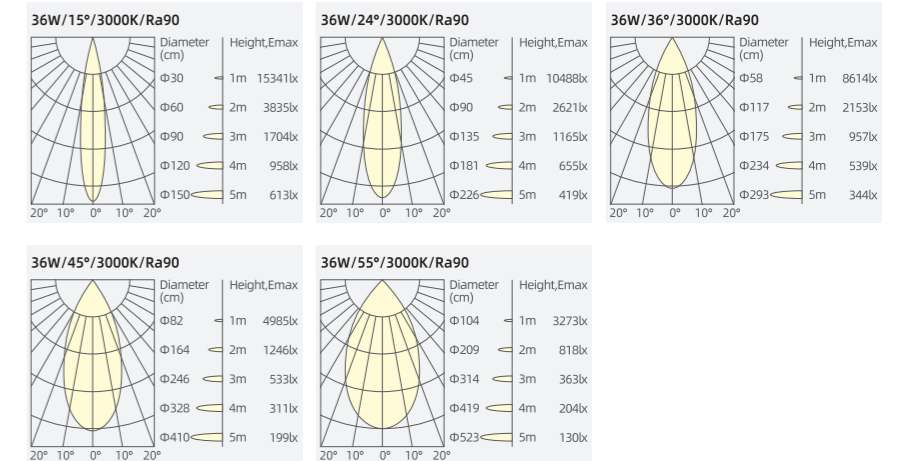

Colour(Reflector)





Glare Cut 37° | 350° | 25° | UGR < 19 | CE | CB

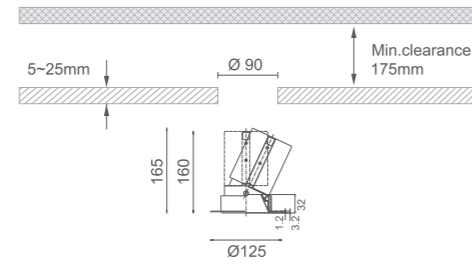

MODERN 12562AW

Colour(Front ring) ● Standard ○ Non-standard

- WHITE ●
- BLACK ●

IP rate ● Standard ○ Non-standard

- IP20 ●
- IP54 ●

CCT ● Standard ○ Non-standard

- 2700K ●
- 3000K ●
- 3500K ●
- 4000K ●
- 5000K ●
- 2700-6000K ●
- 1800-4000K ○
- DTW 1800-3000K ○
- RGBCW ○

Control ● Standard ○ Non-standard

- ON/OFF ●
- DALI ●
- 0/1-10V ●
- TRIAC ●
- BLUETOOTH ○
- ZIGBEE ○
- CASAMBI ○

Optical Accessories

When E01 is selected, the protection level is IP20; Choosing E02, E03, or E04 can achieve IP54 protection level; You can choose one or both: E01+E02, E01+E03, or E01+E04.

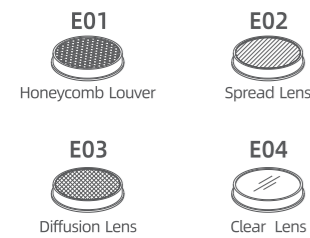

LED 24W/30.5W (CITIZEN LED)

LED Power	System Power	LED Output	System Output	Beam	CCT	CRI	Drive
24W	27.5W	2939lm	1806lm	15°	3000K	> 90	34V 700mA
24W	27.5W	3066lm	2248lm	24°	3000K	> 90	34V 700mA
24W	27.5W	3066lm	2435lm	36°	3000K	> 90	34V 700mA
24W	27.5W	3066lm	2430lm	45°	3000K	> 90	34V 700mA
24W	27.5W	3066lm	2333lm	55°	3000K	> 90	34V 700mA
30.5W	36W	3285lm	1950lm	15°	3000K	> 90	34V 900mA
30.5W	36W	3960lm	2837lm	24°	3000K	> 90	34V 900mA
30.5W	36W	3960lm	2941lm	36°	3000K	> 90	34V 900mA
30.5W	36W	3960lm	2874lm	45°	3000K	> 90	34V 900mA
30.5W	36W	3960lm	2773lm	55°	3000K	> 90	34V 900mA

Light Distribution

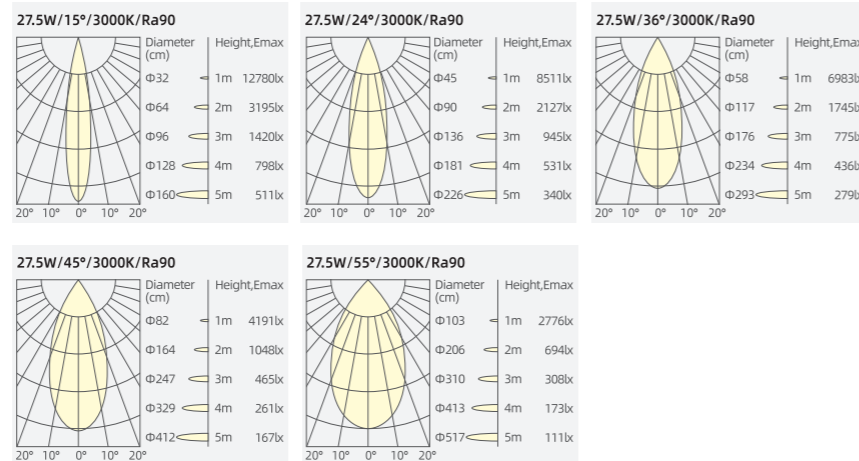

Colour(Reflector)



Glare Cut 37° | 350° | 0° | UGR < 19 | CE | CB

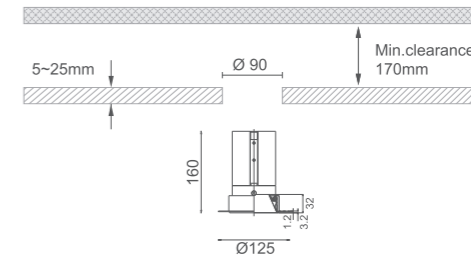

MODERN 12562AD

Colour(Front ring) ● Standard ○ Non-standard

- WHITE ●
- BLACK ●

IP rate ● Standard ○ Non-standard

- IP20 ●
- IP54 ●

CCT ● Standard ○ Non-standard

- 2700K ●
- 3000K ●
- 3500K ●
- 4000K ●
- 5000K ●
- 2700-6000K ●
- 1800-4000K ○
- DTW 1800-3000K ○
- RGBCW ○

Control ● Standard ○ Non-standard

- ON/OFF ●
- DALI ●
- 0/1-10V ●
- TRIAC ●
- BLUETOOTH ○
- ZIGBEE ○
- CASAMBI ○

Optical Accessories

When E01 is selected, the protection level is IP20; Choosing E02, E03, or E04 can achieve IP54 protection level; You can choose one or both: E01+E02, E01+E03, or E01+E04.

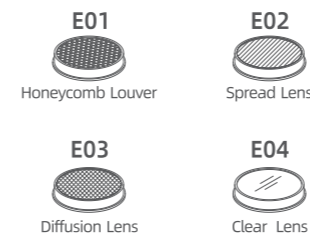

LED 24W/30.5W (CITIZEN LED)

LED Power	System Power	LED Output	System Output	Beam	CCT	CRI	Drive
24W	27.5W	2939lm	1806lm	15°	3000K	> 90	34V 700mA
24W	27.5W	3066lm	2248lm	24°	3000K	> 90	34V 700mA
24W	27.5W	3066lm	2435lm	36°	3000K	> 90	34V 700mA
24W	27.5W	3066lm	2430lm	45°	3000K	> 90	34V 700mA
24W	27.5W	3066lm	2333lm	55°	3000K	> 90	34V 700mA
30.5W	36W	3285lm	1950lm	15°	3000K	> 90	34V 900mA
30.5W	36W	3960lm	2837lm	24°	3000K	> 90	34V 900mA
30.5W	36W	3960lm	2941lm	36°	3000K	> 90	34V 900mA
30.5W	36W	3960lm	2874lm	45°	3000K	> 90	34V 900mA
30.5W	36W	3960lm	2773lm	55°	3000K	> 90	34V 900mA

Light Distribution

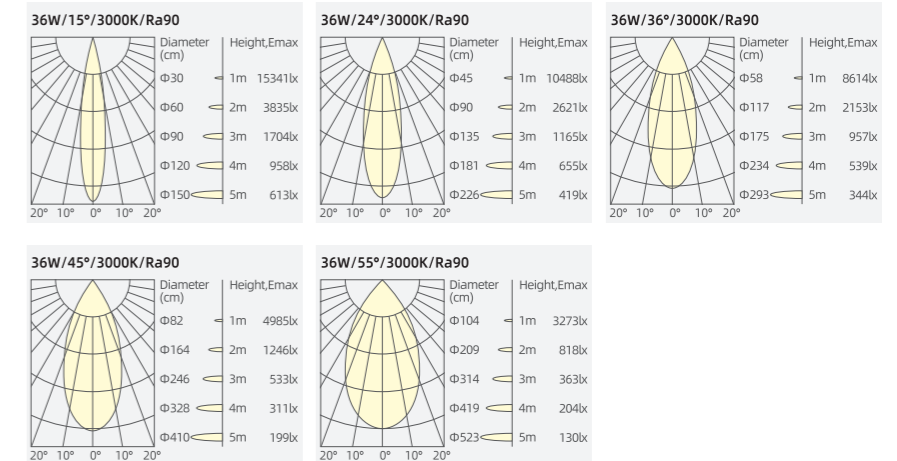

Colour(Reflector)



LED Recessed downlight

LED Recessed downlight



Deep cup

Deep recessed chip, big glare cut angle

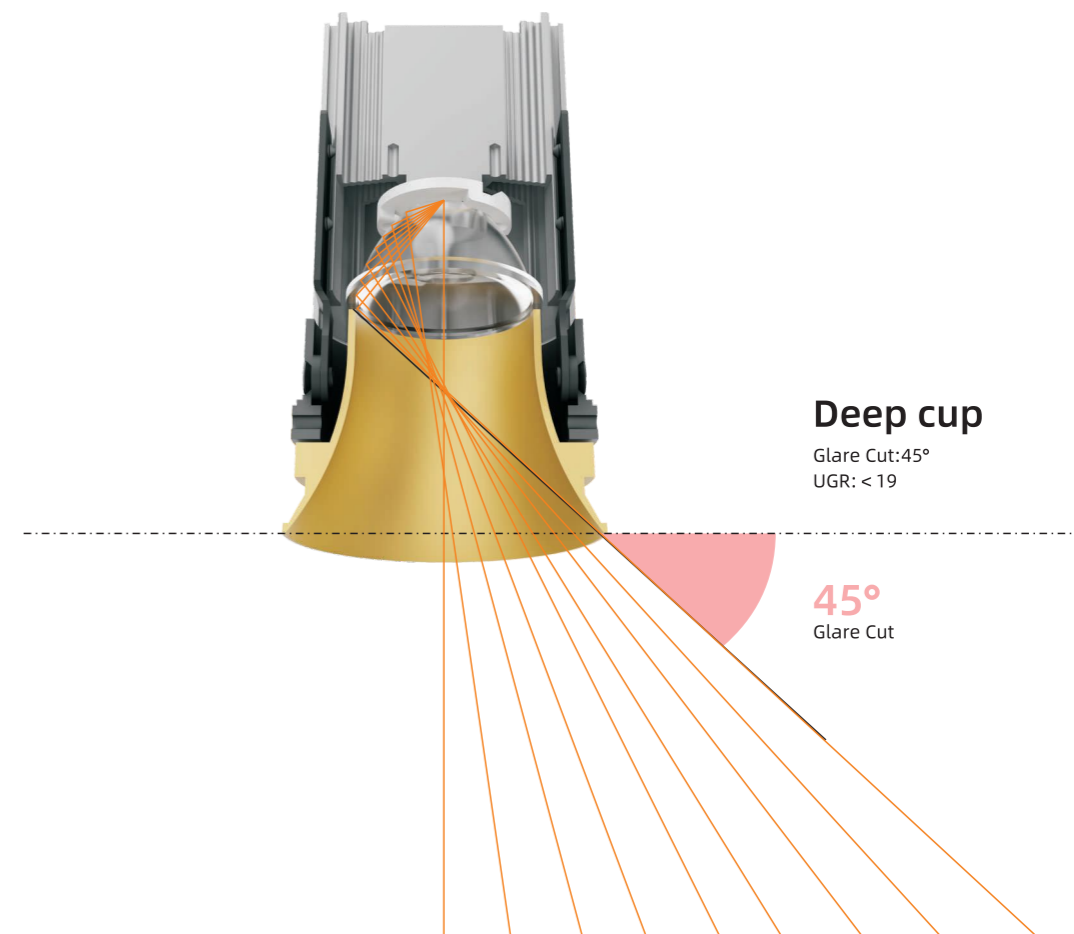

Deep cup

Glare Cut: 45°
UGR: < 19

45°
Glare Cut

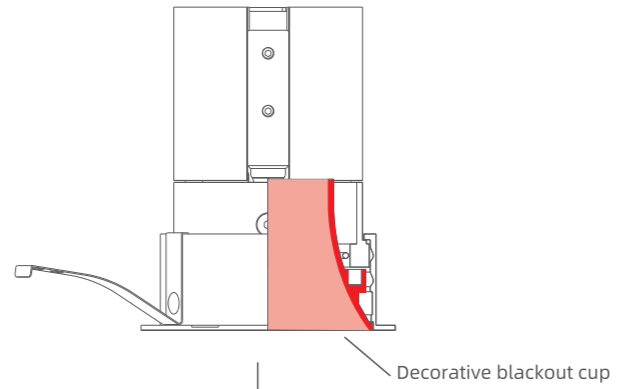

Decorative blackout cup

The application of decorative shading cups not only satisfies the lighting function of lamps, but also achieves decorative effects, creating a sense of spatial atmosphere.



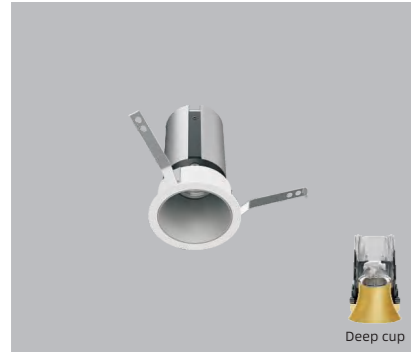

**MODERN
12534AD**

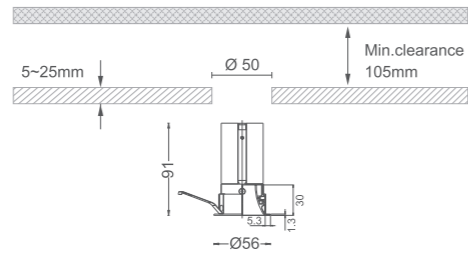

Colour(Front ring)

- Standard
- Non-standard
- WHITE
- BLACK

IP rate

- Standard
- Non-standard
- IP20
- IP54

CCT

- Standard
- Non-standard
- 2700K
- 3000K
- 3500K
- 4000K
- 5000K
- 2700-6000K
- 1800-4000K
- DTW 1800-3000K

Control

- Standard
- Non-standard
- ON/OFF
- DALI
- 0/1-10V
- TRIAC
- BLUETOOTH
- ZIGBEE
- CASAMBI

Optical Accessories

When E01 is selected, the protection level is IP20;
Choosing E02, E03, or E04 can achieve IP54 protection level;
You can choose one or both: E01+E02, E01+E03, or E01+E04.

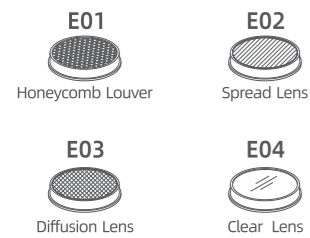

LED 4.5W/6.5W/8W (CITIZEN LED)

LED Power	System Power	LED Output	System Output	Beam	CCT	CRI	Drive
6.5W	7W	660lm	445lm	15°	3000K	> 90	34V 200mA
6.5W	7W	652lm	557lm	24°	3000K	> 90	32V 200mA
6.5W	7W	652lm	604lm	36°	3000K	> 90	32V 200mA
6.5W	7W	652lm	551lm	45°	3000K	> 90	32V 200mA
8W	9W	792lm	581lm	15°	3000K	> 90	34V 250mA
8W	9W	815lm	647lm	24°	3000K	> 90	32V 250mA
8W	9W	815lm	661lm	36°	3000K	> 90	32V 250mA
8W	9W	815lm	638lm	45°	3000K	> 90	32V 250mA

Light Distribution



Colour(Reflector)



**MODERN
12536AD**

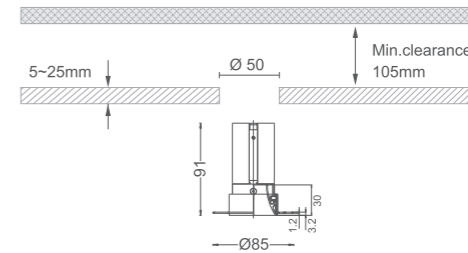

Colour(Front ring)

- Standard
- Non-standard
- WHITE
- BLACK

IP rate

- Standard
- Non-standard
- IP20
- IP54

CCT

- Standard
- Non-standard
- 2700K
- 3000K
- 3500K
- 4000K
- 5000K
- 2700-6000K
- 1800-4000K
- DTW 1800-3000K

Control

- Standard
- Non-standard
- ON/OFF
- DALI
- 0/1-10V
- TRIAC
- BLUETOOTH
- ZIGBEE
- CASAMBI

Optical Accessories

When E01 is selected, the protection level is IP20;
Choosing E02, E03, or E04 can achieve IP54 protection level;
You can choose one or both: E01+E02, E01+E03, or E01+E04.

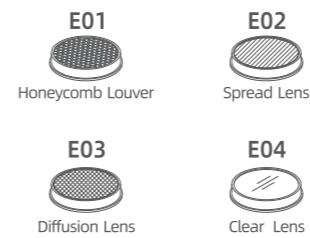

LED 4.5W/6.5W/8W (CITIZEN LED)

LED Power	System Power	LED Output	System Output	Beam	CCT	CRI	Drive
6.5W	7W	660lm	445lm	15°	3000K	> 90	34V 200mA
6.5W	7W	652lm	557lm	24°	3000K	> 90	32V 200mA
6.5W	7W	652lm	604lm	36°	3000K	> 90	32V 200mA
6.5W	7W	652lm	551lm	45°	3000K	> 90	32V 200mA
8W	9W	792lm	581lm	15°	3000K	> 90	34V 250mA
8W	9W	815lm	647lm	24°	3000K	> 90	32V 250mA
8W	9W	815lm	661lm	36°	3000K	> 90	32V 250mA
8W	9W	815lm	638lm	45°	3000K	> 90	32V 250mA

Light Distribution

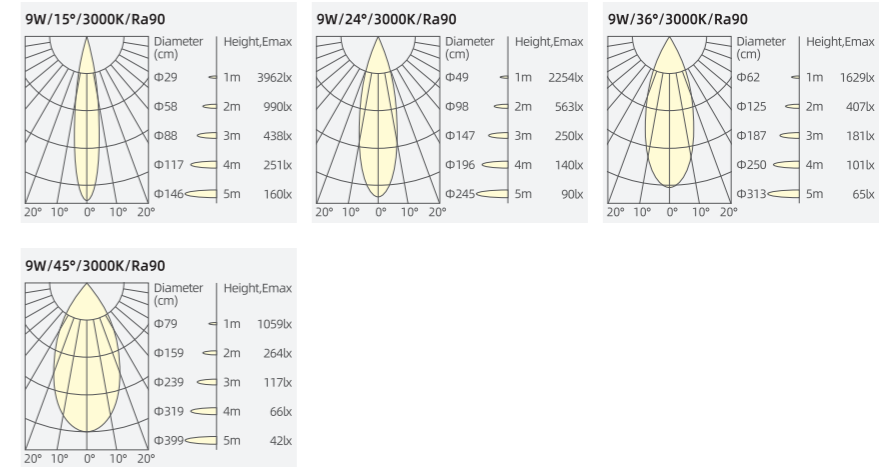

Colour(Reflector)





**MODERN
12544AD**

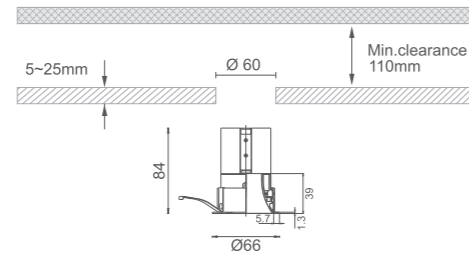

Colour(Front ring)

- Standard
- Non-standard
- WHITE ●
- BLACK ●

IP rate

- Standard
- Non-standard
- IP20 ●
- IP54 ●

CCT

- Standard
- Non-standard
- 2700K ●
- 3000K ●
- 3500K ●
- 4000K ●
- 5000K ●
- 2700-6000K ●
- 1800-4000K ○
- DTW 1800-3000K ○

Control

- Standard
- Non-standard
- ON/OFF ●
- DALI ●
- 0/1-10V ●
- TRIAC ●
- BLUETOOTH ○
- ZIGBEE ○
- CASAMBI ○

Optical Accessories

When E01 is selected, the protection level is IP20; Choosing E02, E03, or E04 can achieve IP54 protection level; You can choose one or both: E01+E02, E01+E03, or E01+E04.

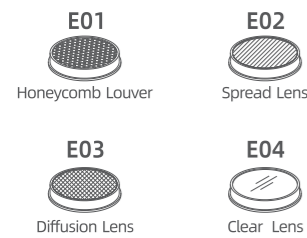

LED 5W/6.5W/8.5W(CITIZEN LED)

LED Power	System Power	LED Output	System Output	Beam	CCT	CRI	Drive
6W	7W	484lm	301lm	8°	3000K	> 90	12V 500mA
6.5W	7W	652lm	481lm	15°	3000K	> 90	32V 200mA
6.5W	8W	922lm	630lm	24°	3000K	> 90	34V 200mA
6.5W	8W	922lm	685lm	36°	3000K	> 90	34V 200mA
6.5W	8W	922lm	682lm	45°	3000K	> 90	34V 200mA
8W	9W	815lm	596lm	15°	3000K	> 90	32V 250mA
8.5W	10W	1067lm	759lm	24°	3000K	> 90	34V 250mA
8.5W	10W	1067lm	837lm	36°	3000K	> 90	34V 250mA
8.5W	10W	1067lm	822lm	45°	3000K	> 90	34V 250mA

Light Distribution

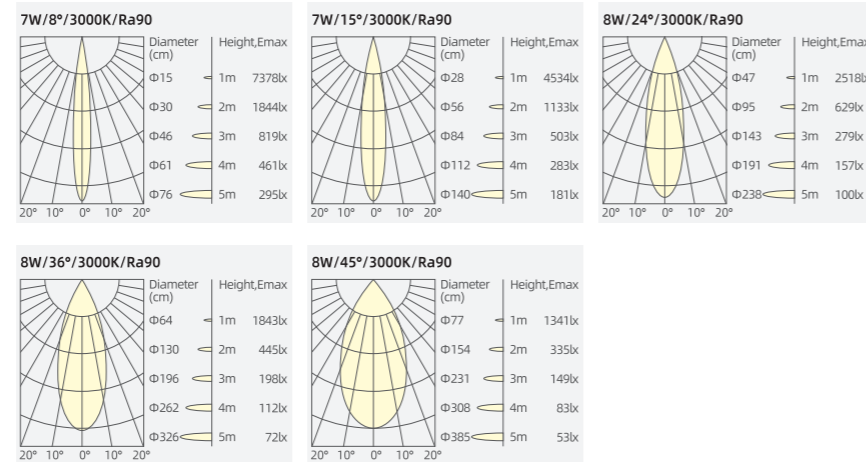

Colour(Reflector)



**MODERN
12545AD**

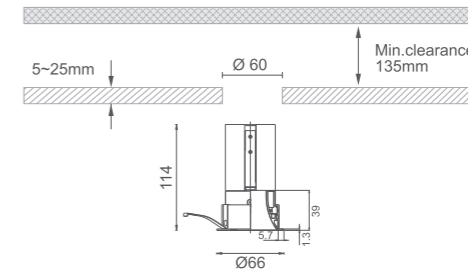

Colour(Front ring)

- Standard
- Non-standard
- WHITE ●
- BLACK ●

IP rate

- Standard
- Non-standard
- IP20 ●
- IP54 ●

CCT

- Standard
- Non-standard
- 2700K ●
- 3000K ●
- 3500K ●
- 4000K ●
- 5000K ●
- 2700-6000K ●
- 1800-4000K ○
- DTW 1800-3000K ○

Control

- Standard
- Non-standard
- ON/OFF ●
- DALI ●
- 0/1-10V ●
- TRIAC ●
- BLUETOOTH ○
- ZIGBEE ○
- CASAMBI ○

Optical Accessories

When E01 is selected, the protection level is IP20; Choosing E02, E03, or E04 can achieve IP54 protection level; You can choose one or both: E01+E02, E01+E03, or E01+E04.

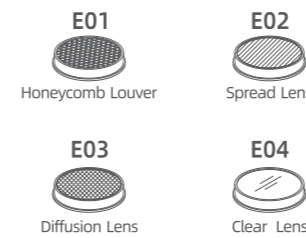

LED 9.5W/11.5W (CITIZEN LED)

LED Power	System Power	LED Output	System Output	Beam	CCT	CRI	Drive
9.5W	10.5W	951lm	679lm	15°	3000K	> 90	32V 300mA
10W	11.5W	1320lm	867lm	24°	3000K	> 90	34V 300mA
10W	11.5W	1320lm	918lm	36°	3000K	> 90	34V 300mA
10W	11.5W	1320lm	955lm	45°	3000K	> 90	34V 300mA
11.5W	12.5W	1087lm	801lm	15°	3000K	> 90	32V 350mA
12W	14W	1650lm	1035lm	24°	3000K	> 90	34V 350mA
12W	14W	1650lm	1163lm	36°	3000K	> 90	34V 350mA
12W	14W	1650lm	1144lm	45°	3000K	> 90	34V 350mA

Light Distribution

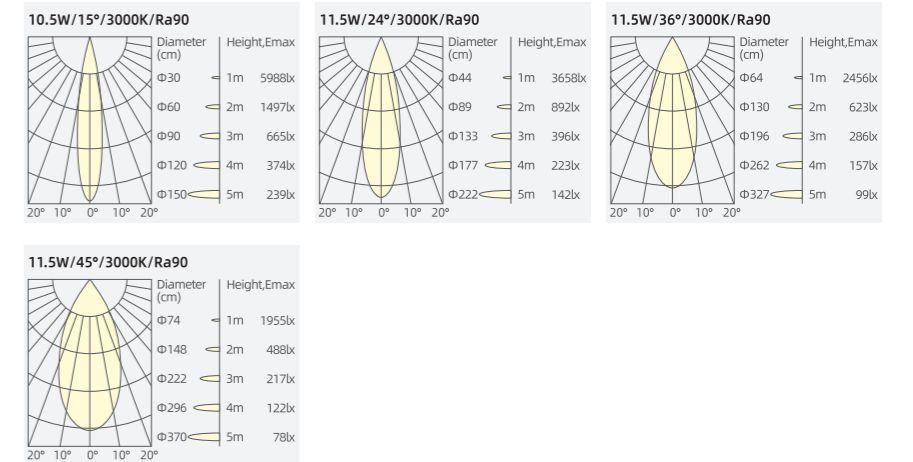

Colour(Reflector)





**MODERN
12546AD**

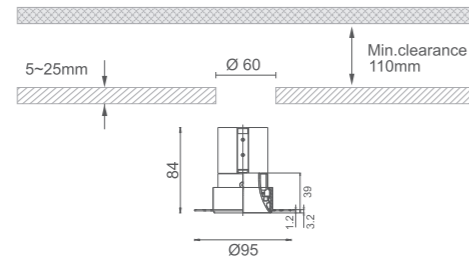

Colour(Front ring)

- Standard
- Non-standard
- WHITE
- BLACK

IP rate

- Standard
- Non-standard
- IP20
- IP54

CCT

- Standard
- Non-standard
- 2700K
- 3000K
- 3500K
- 4000K
- 5000K
- 2700-6000K
- 1800-4000K
- DTW 1800-3000K

Control

- Standard
- Non-standard
- ON/OFF
- DALI
- 0/1-10V
- TRIAC
- BLUETOOTH
- ZIGBEE
- CASAMBI

Optical Accessories

When E01 is selected, the protection level is IP20; Choosing E02, E03, or E04 can achieve IP54 protection level; You can choose one or both: E01+E02, E01+E03, or E01+E04.

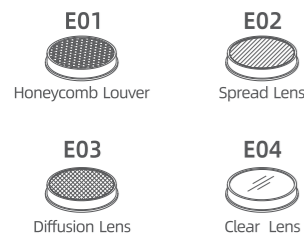

LED 5W/6.5W/8.5W(CITIZEN LED)

LED Power	System Power	LED Output	System Output	Beam	CCT	CRI	Drive
6W	7W	484lm	301lm	8°	3000K	> 90	12V 500mA
6.5W	8W	652lm	481lm	15°	3000K	> 90	32V 200mA
6.5W	8W	922lm	630lm	24°	3000K	> 90	34V 200mA
6.5W	8W	922lm	685lm	36°	3000K	> 90	34V 200mA
6.5W	8W	922lm	682lm	45°	3000K	> 90	34V 200mA
8W	9W	815lm	596lm	15°	3000K	> 90	32V 250mA
8.5W	10W	1067lm	759lm	24°	3000K	> 90	34V 250mA
8.5W	10W	1067lm	837lm	36°	3000K	> 90	34V 250mA
8.5W	10W	1067lm	822lm	45°	3000K	> 90	34V 250mA

Light Distribution

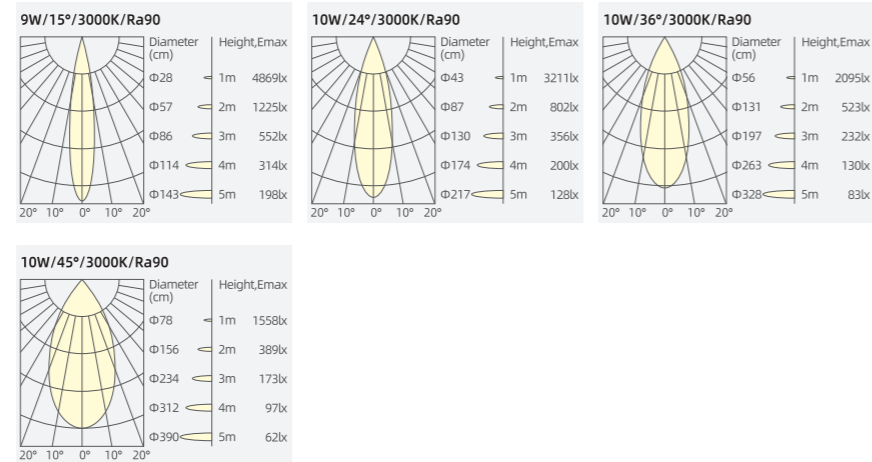

Colour(Reflector)



**MODERN
12547AD**

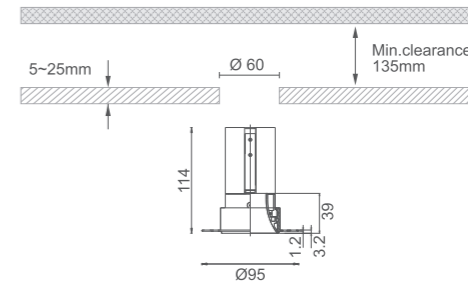

Colour(Front ring)

- Standard
- Non-standard
- WHITE
- BLACK

IP rate

- Standard
- Non-standard
- IP20
- IP54

CCT

- Standard
- Non-standard
- 2700K
- 3000K
- 3500K
- 4000K
- 5000K
- 2700-6000K
- 1800-4000K
- DTW 1800-3000K

Control

- Standard
- Non-standard
- ON/OFF
- DALI
- 0/1-10V
- TRIAC
- BLUETOOTH
- ZIGBEE
- CASAMBI

Optical Accessories

When E01 is selected, the protection level is IP20; Choosing E02, E03, or E04 can achieve IP54 protection level; You can choose one or both: E01+E02, E01+E03, or E01+E04.

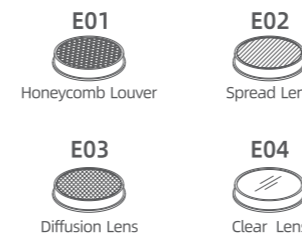

LED 10W/12W (CITIZEN LED)

LED Power	System Power	LED Output	System Output	Beam	CCT	CRI	Drive
9.5W	10.5W	951lm	679lm	15°	3000K	> 90	32V 300mA
10W	11.5W	1320lm	867lm	24°	3000K	> 90	34V 300mA
10W	11.5W	1320lm	918lm	36°	3000K	> 90	34V 300mA
10W	11.5W	1320lm	955lm	45°	3000K	> 90	34V 300mA
11.5W	12.5W	1087lm	628lm	15°	3000K	> 90	32V 350mA
12W	14W	1650lm	1035lm	24°	3000K	> 90	34V 350mA
12W	14W	1650lm	1163lm	36°	3000K	> 90	34V 350mA
12W	14W	1650lm	1144lm	45°	3000K	> 90	34V 350mA

Light Distribution

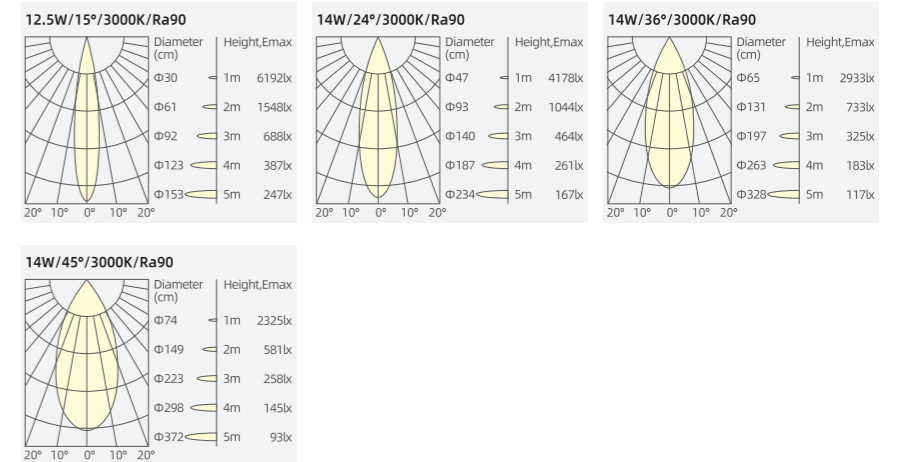

Colour(Reflector)



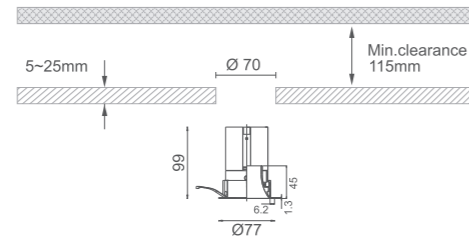

**MODERN
12544AD**

Colour(Front ring)

- Standard
- Non-standard
- WHITE
- BLACK

IP rate

- Standard
- Non-standard
- IP20
- IP54

CCT

- Standard
- Non-standard
- 2700K
- 3000K
- 3500K
- 4000K
- 5000K
- 2700-6000K
- 1800-4000K
- DTW 1800-3000K
- RGBCW

Control

- Standard
- Non-standard
- ON/OFF
- DALI
- 0/1-10V
- TRIAC
- BLUETOOTH
- ZIGBEE
- CASAMBI

Optical Accessories

When E01 is selected, the protection level is IP20;
Choosing E02, E03, or E04 can achieve IP54 protection level;
You can choose one or both: E01+E02, E01+E03, or E01+E04.

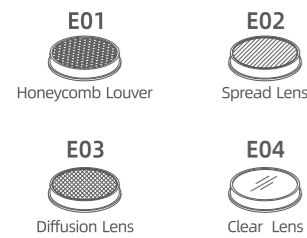

LED 8.5W/10W(CITIZEN LED)

LED Power	System Power	LED Output	System Output	Beam	CCT	CRI	Drive
6W	7W	484lm	360lm	6°	3000K	> 90	12V 500mA
9W	11W	792lm	574lm	10°	3000K	> 90	36V 250mA
8W	9W	951lm	702lm	15°	3000K	> 90	32V 250mA
8.5W	10W	1067lm	908lm	20°	3000K	> 90	34V 250mA
8.5W	10W	1067lm	919lm	30°	3000K	> 90	34V 250mA
8.5W	10W	1067lm	927lm	40°	3000K	> 90	34V 250mA
8.5W	10W	1067lm	895lm	50°	3000K	> 90	34V 250mA
10.5W	12W	946lm	666lm	10°	3000K	> 90	36V 300mA
9.5W	10.5W	1087lm	767lm	15°	3000K	> 90	32V 300mA
10W	11.5W	1320lm	1034lm	20°	3000K	> 90	34V 300mA
10W	11.5W	1320lm	1070lm	30°	3000K	> 90	34V 300mA
10W	11.5W	1320lm	1077lm	40°	3000K	> 90	34V 300mA
10W	11.5W	1320lm	1056lm	50°	3000K	> 90	34V 300mA

Light Distribution

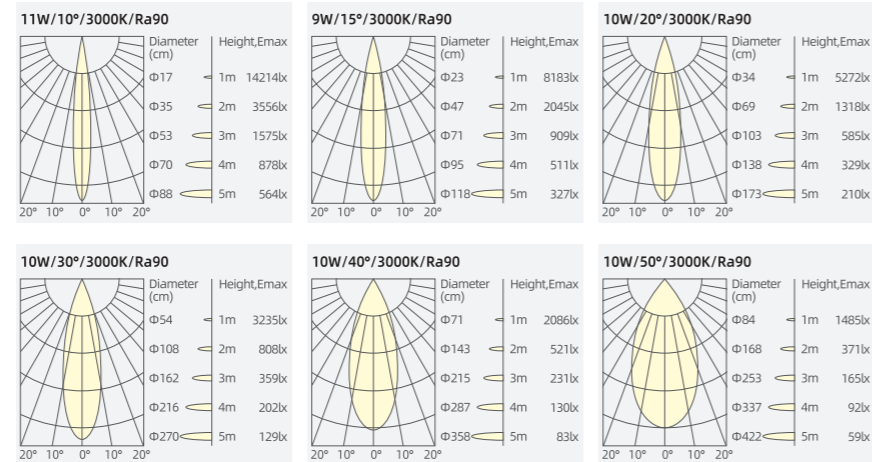

Colour(Reflector)

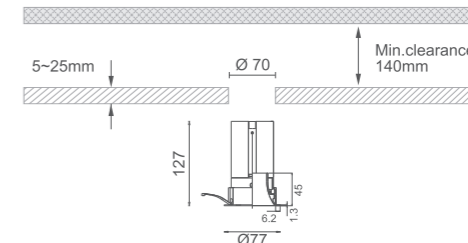

**MODERN
12555AD**

Colour(Front ring)

- Standard
- Non-standard
- WHITE
- BLACK

IP rate

- Standard
- Non-standard
- IP20
- IP54

CCT

- Standard
- Non-standard
- 2700K
- 3000K
- 3500K
- 4000K
- 5000K
- 2700-6000K
- 1800-4000K
- DTW 1800-3000K
- RGBCW

Control

- Standard
- Non-standard
- ON/OFF
- DALI
- 0/1-10V
- TRIAC
- BLUETOOTH
- ZIGBEE
- CASAMBI

Optical Accessories

When E01 is selected, the protection level is IP20;
Choosing E02, E03, or E04 can achieve IP54 protection level;
You can choose one or both: E01+E02, E01+E03, or E01+E04.

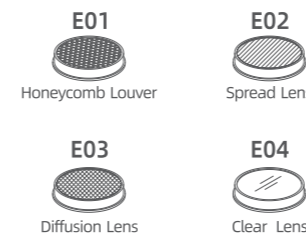

LED 12W/18W (CITIZEN LED)

LED Power	System Power	LED Output	System Output	Beam	CCT	CRI	Drive
12.5W	14.5W	946lm	707lm	10°	3000K	> 90	36V 350mA
11W	12.5W	1087lm	890lm	15°	3000K	> 90	32V 350mA
12W	14W	1650lm	1271lm	20°	3000K	> 90	34V 350mA
12W	14W	1650lm	1299lm	30°	3000K	> 90	34V 350mA
12W	14W	1650lm	1298lm	40°	3000K	> 90	34V 350mA
12W	14W	1650lm	1269lm	50°	3000K	> 90	34V 350mA
18W	20W	1926lm	1196lm	15°	3000K	> 90	34V 500mA
18W	20W	2343lm	1756lm	20°	3000K	> 90	34V 500mA
18W	20W	2343lm	1789lm	30°	3000K	> 90	34V 500mA
18W	20W	2343lm	1824lm	40°	3000K	> 90	34V 500mA
18W	20W	2343lm	1805lm	50°	3000K	> 90	34V 500mA

Light Distribution

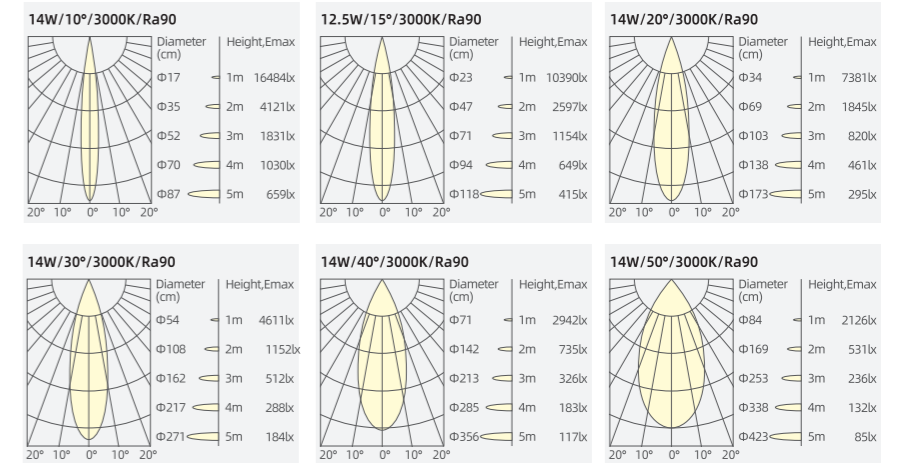

Colour(Reflector)





**MODERN
12556AD**

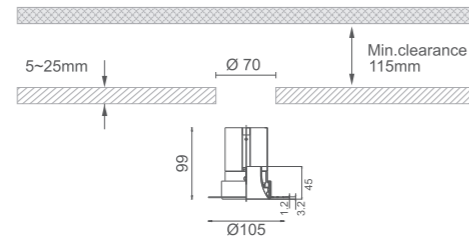

Colour(Front ring)

- Standard
- Non-standard
- WHITE ●
- BLACK ●

IP rate

- Standard
- Non-standard
- IP20 ●
- IP54 ●

CCT

- Standard
- Non-standard
- 2700K ●
- 3000K ●
- 3500K ●
- 4000K ●
- 5000K ●
- 2700-6000K ●
- 1800-4000K ○
- DTW 1800-3000K ○
- RGBCW ○

Control

- Standard
- Non-standard
- ON/OFF ●
- DALI ●
- 0/1-10V ●
- TRIAC ●
- BLUETOOTH ○
- ZIGBEE ○
- CASAMBI ○

Optical Accessories

When E01 is selected, the protection level is IP20;
Choosing E02, E03, or E04 can achieve IP54 protection level;
You can choose one or both: E01+E02, E01+E03, or E01+E04.

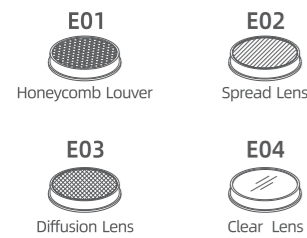

LED 8.5W/10W(CITIZEN LED)

LED Power	System Power	LED Output	System Output	Beam	CCT	CRI	Drive
6W	7W	484lm	360lm	6°	3000K	> 90	12V 500mA
9W	11W	792lm	574lm	10°	3000K	> 90	36V 250mA
8W	9W	951lm	702lm	15°	3000K	> 90	32V 250mA
8.5W	10W	1067lm	908lm	20°	3000K	> 90	34V 250mA
8.5W	10W	1067lm	919lm	30°	3000K	> 90	34V 250mA
8.5W	10W	1067lm	927lm	40°	3000K	> 90	34V 250mA
8.5W	10W	1067lm	895lm	50°	3000K	> 90	34V 250mA
10.5W	12W	946lm	666lm	10°	3000K	> 90	36V 300mA
9.5W	10.5W	1087lm	767lm	15°	3000K	> 90	32V 300mA
10W	11.5W	1320lm	1034lm	20°	3000K	> 90	34V 300mA
10W	11.5W	1320lm	1070lm	30°	3000K	> 90	34V 300mA
10W	11.5W	1320lm	1077lm	40°	3000K	> 90	34V 300mA
10W	11.5W	1320lm	1056lm	50°	3000K	> 90	34V 300mA

Light Distribution

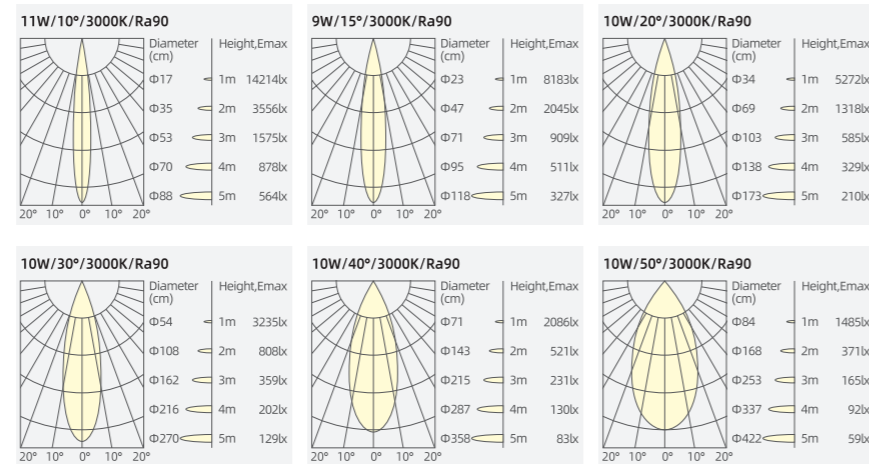

Colour(Reflector)



**MODERN
12557AD**

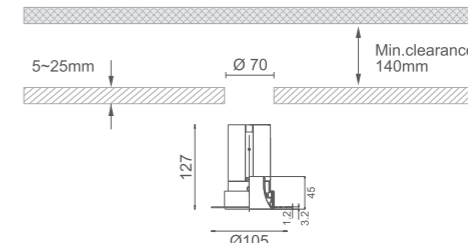

Colour(Front ring)

- Standard
- Non-standard
- WHITE ●
- BLACK ●

IP rate

- Standard
- Non-standard
- IP20 ●
- IP54 ●

CCT

- Standard
- Non-standard
- 2700K ●
- 3000K ●
- 3500K ●
- 4000K ●
- 5000K ●
- 2700-6000K ●
- 1800-4000K ○
- DTW 1800-3000K ○
- RGBCW ○

Control

- Standard
- Non-standard
- ON/OFF ●
- DALI ●
- 0/1-10V ●
- TRIAC ●
- BLUETOOTH ○
- ZIGBEE ○
- CASAMBI ○

Optical Accessories

When E01 is selected, the protection level is IP20;
Choosing E02, E03, or E04 can achieve IP54 protection level;
You can choose one or both: E01+E02, E01+E03, or E01+E04.

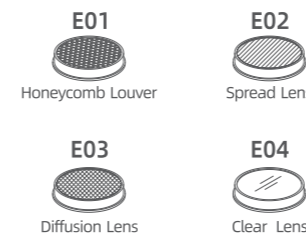

LED 12W/18W (CITIZEN LED)

LED Power	System Power	LED Output	System Output	Beam	CCT	CRI	Drive
12.5W	14.5W	946lm	707lm	10°	3000K	> 90	36V 350mA
11W	12.5W	1087lm	890lm	15°	3000K	> 90	32V 350mA
12W	14W	1650lm	1271lm	20°	3000K	> 90	34V 350mA
12W	14W	1650lm	1299lm	30°	3000K	> 90	34V 350mA
12W	14W	1650lm	1298lm	40°	3000K	> 90	34V 350mA
12W	14W	1650lm	1269lm	50°	3000K	> 90	34V 350mA
18W	20W	1926lm	1196lm	15°	3000K	> 90	34V 500mA
18W	20W	2343lm	1756lm	20°	3000K	> 90	34V 500mA
18W	20W	2343lm	1789lm	30°	3000K	> 90	34V 500mA
18W	20W	2343lm	1824lm	40°	3000K	> 90	34V 500mA
18W	20W	2343lm	1805lm	50°	3000K	> 90	34V 500mA

Light Distribution

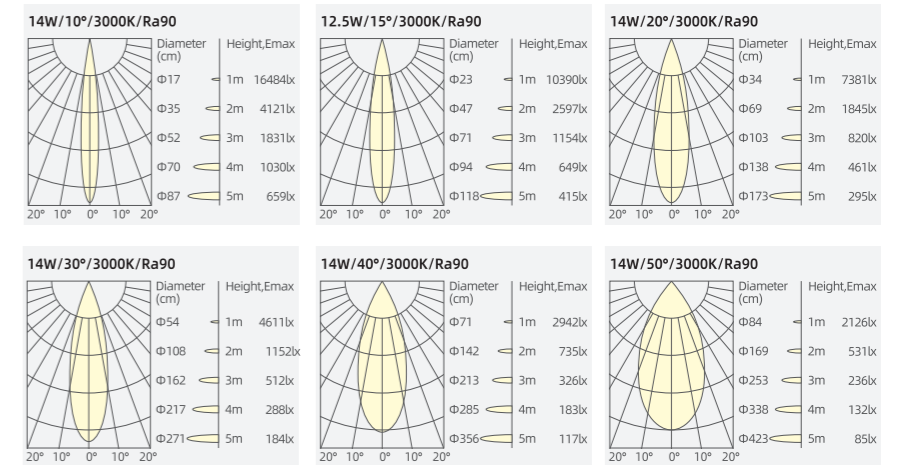

Colour(Reflector)





**MODERN
12564AD**

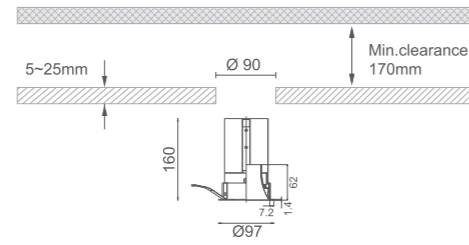

Colour(Front ring)

- Standard
- Non-standard
- WHITE ●
- BLACK ●

IP rate

- Standard
- Non-standard
- IP20 ●
- IP54 ●

CCT

- Standard
- Non-standard
- 2700K ●
- 3000K ●
- 3500K ●
- 4000K ●
- 5000K ●
- 2700-6000K ●
- 1800-4000K ○
- DTW 1800-3000K ○
- RGBCW ○

Control

- Standard
- Non-standard
- ON/OFF ●
- DALI ●
- 0/1-10V ●
- TRIAC ●
- BLUETOOTH ○
- ZIGBEE ○
- CASAMBI ○

Optical Accessories

When E01 is selected, the protection level is IP20;
Choosing E02, E03, or E04 can achieve IP54 protection level;
You can choose one or both: E01+E02, E01+E03, or E01+E04.

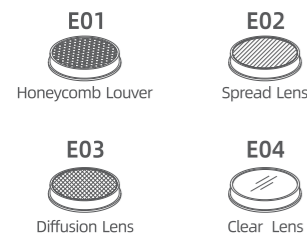

LED 24W/30.5W (CITIZEN LED)

LED Power	System Power	LED Output	System Output	Beam	CCT	CRI	Drive
24W	27.5W	2939lm	2000lm	15°	3000K	> 90	34V 700mA
24W	27.5W	3066lm	2219lm	24°	3000K	> 90	34V 700mA
24W	27.5W	3066lm	2430lm	36°	3000K	> 90	34V 700mA
24W	27.5W	3066lm	2331lm	45°	3000K	> 90	34V 700mA
24W	27.5W	3066lm	2241lm	55°	3000K	> 90	34V 700mA
30.5W	36W	3285lm	2571lm	15°	3000K	> 90	34V 900mA
30.5W	36W	3960lm	2706lm	24°	3000K	> 90	34V 900mA
30.5W	36W	3960lm	2956lm	36°	3000K	> 90	34V 900mA
30.5W	36W	3960lm	2853lm	45°	3000K	> 90	34V 900mA
30.5W	36W	3960lm	2811lm	55°	3000K	> 90	34V 900mA

Light Distribution

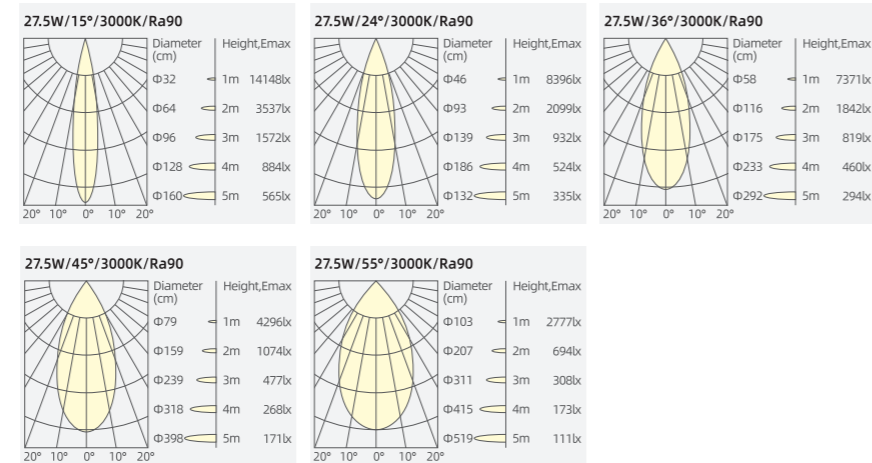

Colour(Reflector)



**MODERN
12566AD**

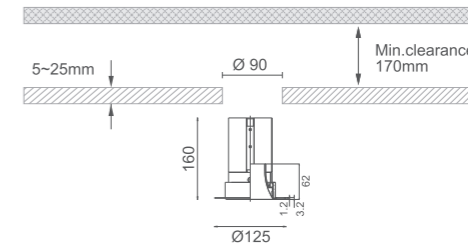

Colour(Front ring)

- Standard
- Non-standard
- WHITE ●
- BLACK ●

IP rate

- Standard
- Non-standard
- IP20 ●
- IP54 ●

CCT

- Standard
- Non-standard
- 2700K ●
- 3000K ●
- 3500K ●
- 4000K ●
- 5000K ●
- 2700-6000K ●
- 1800-4000K ○
- DTW 1800-3000K ○
- RGBCW ○

Control

- Standard
- Non-standard
- ON/OFF ●
- DALI ●
- 0/1-10V ●
- TRIAC ●
- BLUETOOTH ○
- ZIGBEE ○
- CASAMBI ○

Optical Accessories

When E01 is selected, the protection level is IP20;
Choosing E02, E03, or E04 can achieve IP54 protection level;
You can choose one or both: E01+E02, E01+E03, or E01+E04.

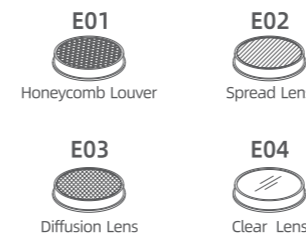

LED 24W/30.5W (CITIZEN LED)

LED Power	System Power	LED Output	System Output	Beam	CCT	CRI	Drive
24W	27.5W	2939lm	2000lm	15°	3000K	> 90	34V 700mA
24W	27.5W	3066lm	2219lm	24°	3000K	> 90	34V 700mA
24W	27.5W	3066lm	2430lm	36°	3000K	> 90	34V 700mA
24W	27.5W	3066lm	2331lm	45°	3000K	> 90	34V 700mA
24W	27.5W	3066lm	2241lm	55°	3000K	> 90	34V 700mA
30.5W	36W	3285lm	2571lm	15°	3000K	> 90	34V 900mA
30.5W	36W	3960lm	2706lm	24°	3000K	> 90	34V 900mA
30.5W	36W	3960lm	2956lm	36°	3000K	> 90	34V 900mA
30.5W	36W	3960lm	2853lm	45°	3000K	> 90	34V 900mA
30.5W	36W	3960lm	2811lm	55°	3000K	> 90	34V 900mA

Light Distribution

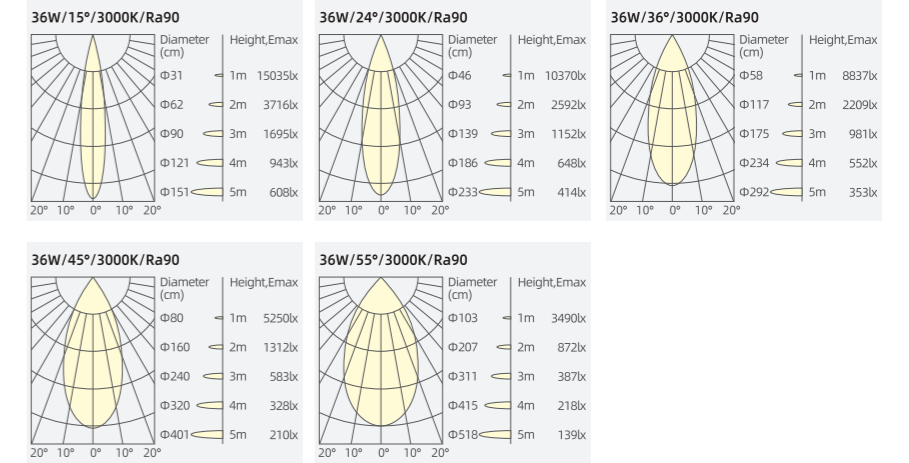

Colour(Reflector)

