

Specifications - AURORA BL01LED Bollard Light

Version: 3.0



RoHS

Electrical Information		
Model No.	AURORA BL01-014A	AURORA BL01-024A
Power Consumption (W)	14	24
Power Supply	LIFUD	
Input Voltage	220-240 VAC, 50/60 Hz (Lamp body) 16A 250VAC, 60Hz (Germany Socket)	
Power Factor	>0.9	
Surge Protection	0.5kV line-line, 2kV line-earth / 1kV line-line, 2kV line-earth (LIFUD) Constant	
Driver Type	current (CC)	
Control	DALI (LIFUD)	
Note	NA	

* The tolerance for power is $\pm 5\%$.

Optic Information		
LED Type	LED 3030	
Luminous Flux (lm)	1190	1920
Efficacy (lm/W)	85	80
Correlated Color Temperature	4000K (3000K, 5000K optional)	
Color Rendering Index	Ra80 (Ra70 optional)	
Beam Angle	R03201, R03202, R03203	
UGR level	NA	

* The tolerance for luminous flux is $\pm 10\%$.

Description

AURORA BL01 series is an innovative bollard light which enhances the aesthetic and creativeness of city with IP65 outdoor waterproof performance. Thanks to its architectural merging design and UV-resistant PC material to accommodate the demands of different areas in outdoor pathways. This BL01 new version is integrated with Germany socket, widely used for gardens, sidewalks, building entrance and etc.

Key Features

- Sleek and contemporary aesthetic design
- Germany Socket with leak protection for convenient outdoor power access
- IP65 & IK10
- Visor available for multiple applications
- Professional Type IV / Type V light distribution

Applications

- Gardens
- Pathways
- Sidewalk
- Building entrance

Dimensions and Mount

Product Dimension (mm)	$\phi 165 \times 900$
Luminaire Net Weight (kg) (All-in-one package)	7.1
Export Carton Size (mm) (All-in-one package)	1065x210x215
Gross Weight (kg) (All-in-one package)	8.1
Export Carton Size (mm) (Separated package)	Lamp body: 360 x 210 x 215 Lamp holder: 915x210x215
Luminaire Net Weight (kg) (Separated package)	Lamp body: 2.2 Lamp holder: 4.9
Gross Weight (kg) (Separated package)	Lamp body: 2.66 Lamp holder: 5.8
Mounting Option	Mounting kit with anchor bolts
Material	Aluminum alloy Polycarbonate optical lens
Finish	Powder coating
Fixture Color	Black (RAL 9017)
EPA	NA
IK Rating	IK10
IP Rating	IP66
Category of corrosion	C3 (ISO 9223:2012)

* The tolerance for weight is $\pm 6\%$.

Lifespan and Warranty

Operating Temperature (°C)	-30 to +50
Lifespan of LED @Ta=25°C (hours)	L90-37800
	L80-78500
	L70-124600
Warranty (years)	5

New Features

- 10KV SPD available (optional)

* Please consult us for details.

Specifications - BL01 (Germany Socket) LED Bollard Light

Version: 3.0

Photometry

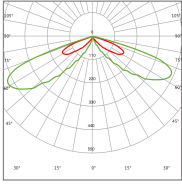

R03201

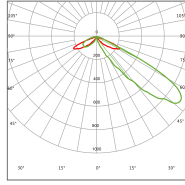

R03202

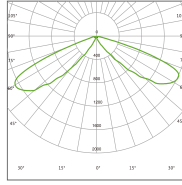

R03203

Mounting Options

Mounting kit with anchor bolts

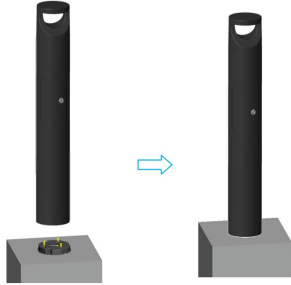

Dimensions

Unit:mm

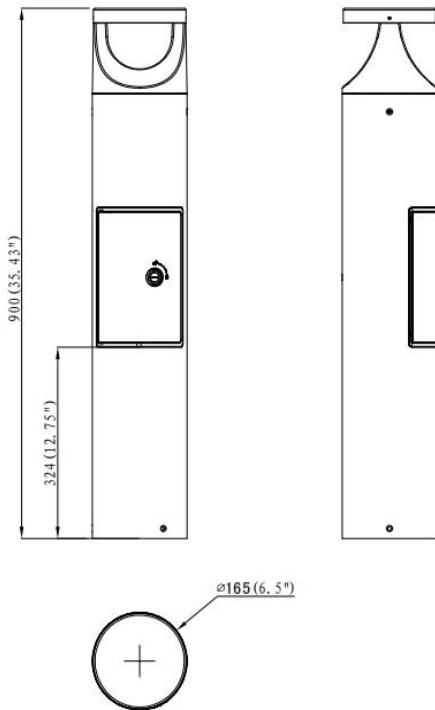

Accessories



Round House Side Shield
To reduce glare light

Code: BC-B01-02



Backfilled Anchor
Q235 +SPCC, hot dip galvanizing
Φ130x508mm.

Code: MT-B01-02